



Spec Sheet

DRK 20M

Remote controlled motorized rigging frame for DVA Line Array systems



Applications

- Live sound for rental application in mid-sized and large venues
- Permanent installation in theatres, houses of worship, convention centres, ballrooms

Features

- Flybar for hanging DVA line array systems (DVA T4, T8 and T12 module; S09 DP, S10 DP, S1518 N, S2585 N subwoofers)
- Used to hang binding loads up to 1000Kg (depending on the inclination angle)
- Angle controlled by manual remote controller and RDNet connection

Description

DRK 20M is a motorized rigging frame designed for lifting DVA line array systems. It can be used to lift DVA T4, T8 and T12 active line-array modules and DVA S09 DP, S10 DP, S1518 N, S2585 N active subwoofers. The inclination angle of the cluster can be changed in real time by a manual remote control or through an RDNet connection, facilitating a lot the installation of line array systems.

Thanks to its solid structure in special steel, it

is possible to hang DVA series speakers with a weight of up to 1000 kg, TUV certified. The maximum inclination angle is +/- 25°, depending on the load applied. The whole hanging system have been designed and verified by technical load-tests, according to the Italian Ministerial Decree "New technical standards for construction" of 14 January 2008, and to Eurocode 1 and Eurocode 3 standards for steel structures.

The DRK 20M comes with a waterproof protection cover that, even if it doesn't increase the declared IP protection degree, helps a lot in particular environmental conditions, such as rain, high degree of moisture and high concentration of dust.

In addition to the rigging frame and the protective cover, the DRK 20M kit includes the remote control, a 70cm PowerCon-to-PowerCon power supply link cable, a 75cm RJ45-to-RJ45 link cable and a couple of fixing pins to attach the flybar to the first module.

Finally, DVA Composer – the Acoustical Simulation and Aiming software for DVA Systems – allows the user to easily design systems composed by clusters hooked to the DRK 20M. The DVA Composer also gives to the user all the information about phase alignment between flown systems and ground stacked subwoofers, as well as it suggests an optimized aiming of the line arrays modules and their suggested EQ preset, in order to guarantee maximum performances even for non-expert customers.

Installation Examples

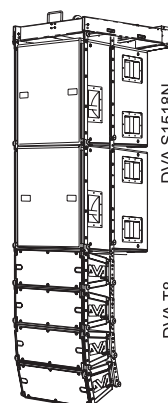
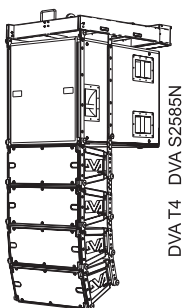
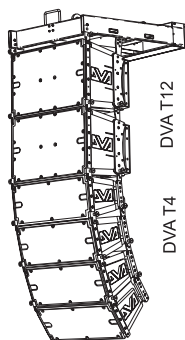

DRK 20M

Technical Specifications

Connections

Power Supply Input	1 POWER-CON connector (Blue)
Power Supply Link	1 POWER-CON connector (Grey)
RDnet Input	1 RJ45 connector (EtherCon) for CAT 5 cable 1 three-pole XLR male socket (as alternative to RJ45)
RDnet Link	1 RJ45 connector (EtherCon) for CAT 5 cable
Remote control	1 three-pole XLR female socket
Computer (upgrade)	1 USB connector (B type)

Indication

Active / Link / Power ON	1 LED Yellow / 1 LED Green / 1 LED Green
--------------------------	--

Power Supply

Voltage	Full-range 100-240V- 50-60Hz
Power consumption	85Wmax

Mechanical

Material	Steel
Colour	Black
Cover material	Nylon waterproof
Handle	2
Dimensions max (WxHxD)	560 x 180 x 840mm - 22.05 x 7.09 x 33.07in
Weight	37,0Kg - 81,57lbs.

Remote Control DRK 20M

Connection	1 three-pole XLR male socket
Dimensions (WxHxD)	35 x 25 x 110mm - 1.38 x 0.98 x 4.33in
Weight	0,2Kg - 0.44lbs.

Kit Setting

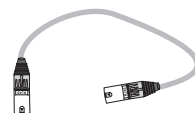
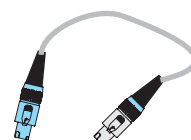
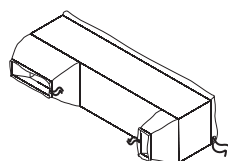
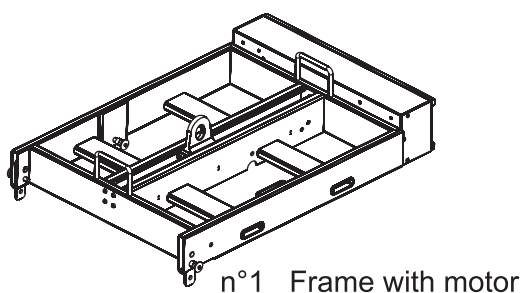

DRK 20M

Technical Specifications

Rear Panel



Remote Control Panel

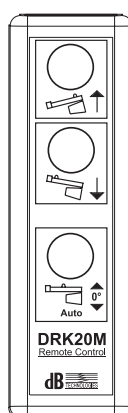

Overall Dimensions

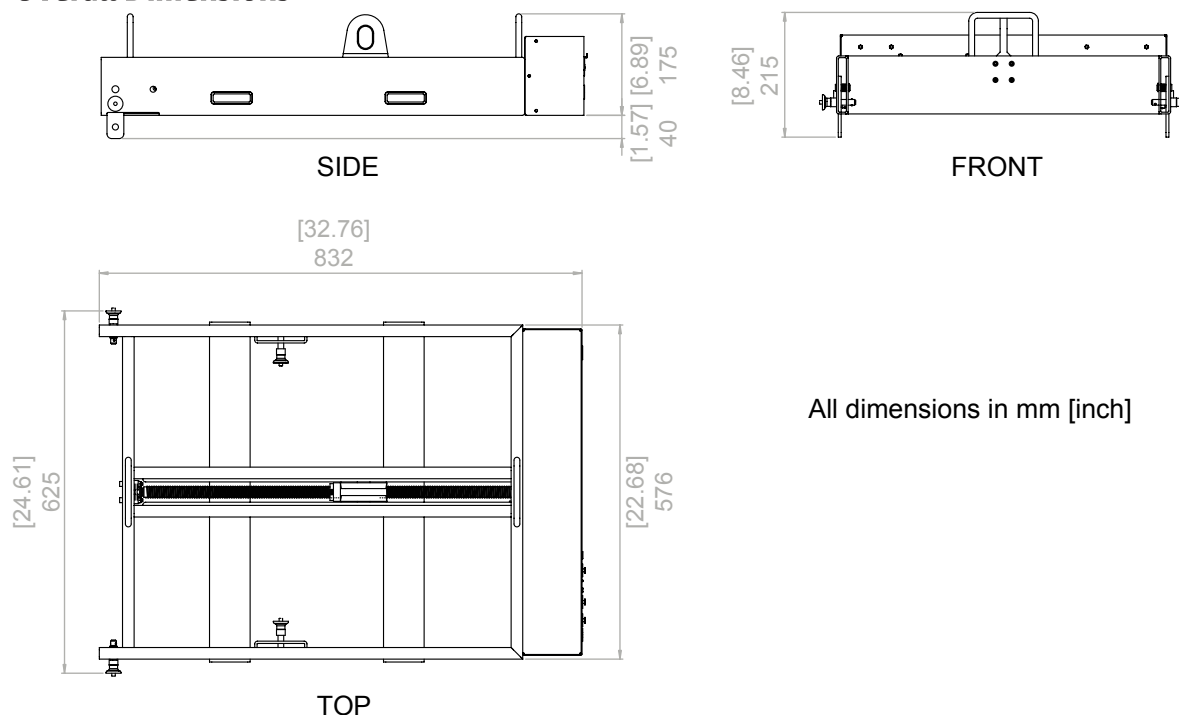

All dimensions in mm [inch]

info@dbtechnologies.com www.dbtechnologies.com

dB Technologies products are continually improved. All specifications are therefore subject to change without notice.