



dBTechnologies

PROFESSIONAL
AUDIO
2024

dBTechnologies was born in 1990 in Bologna, Italy, at the headquarters of AEB Industriale S.r.l., an Italian company with deep-rooted know-how in the professional audio industry. Since 1973, AEB Industriale spans decades under the sign of pure passion for audio technology and a strong specialization in sound reinforcement solutions. In just a few years, AEB Industriale's perspectives have become vibrant thanks to the prodigious development of the dBTechnologies brand, which achieved international recognition by designing,

manufacturing, and distributing highly innovative solutions for the audio field. In the early 2000s, new strategies brought business expansion when AEB Industriale's CEO Arturo Vicari acquired the Italian brand RCF and founded RCF Group (2004) as an international audio holding leader.

Today, dBTechnologies products are distributed in more than 160 countries worldwide and its technology continues nurturing that decades-long expertise thanks to a history of national and international experiences, dynamic developments, excellent services,

strategic and passionate investments in constant research and young talents.

With an unmistakable identity and a soul devoted to progress and innovation, the Company and its brand keep honouring their mission: bringing top-quality systems to the widest base of users worldwide while standing as an industry pioneer and a solid guide for all its people and partners.

The year 2023 represents a prestigious and exciting achievement as AEB Industriale s.r.l. celebrates its 50th anniversary, a first milestone studded with growth and success.

Product Index

OPERA REEVO Series	4	FLEXSYS Series	22	SUB Series	30
OPERA REEVO 210	Active Speaker	FLEXSYS FMX10	Active Stage Monitor	SUB 915	Active Subwoofer
OPERA REEVO 212	Active Speaker	FLEXSYS FMX12	Active Stage Monitor	SUB 918	Active Subwoofer
		FLEXSYS FMX15	Active Stage Monitor	SUB 612	Active Subwoofer
				SUB 615	Active Subwoofer
				SUB 618	Active Subwoofer
INGENIA Series	8	OPERA Series	24	MINIBOX Series	34
INGENIA IG1T	Active Speaker	OPERA 10	Active Speaker	MINIBOX L160D	Active Speaker
INGENIA IG2T	Active Speaker	OPERA 12	Active Speaker	MINIBOX K70	Active Speaker
INGENIA IG3T	Active Speaker	OPERA 15	Active Speaker	MINIBOX K162	Active Speaker
INGENIA IG4T	Active Speaker			MINIBOX K300	Active Speaker
RDNet- EH	RDNet Ingenia Handle				
ES Entertainment System	14	KL Series	26	ELECTRONICS	37
ES 1203	Portable Stereo System	KL 10	Active Speaker		
ES 1002	Portable System	KL 12	Active Speaker		
ES 503	Portable Stereo System	KL 15	Active Speaker		
ES 802	Portable System				
LVX Series	20	B-Hype Series	28	ACCESSORIES	38
LVX 8	Active Speaker	B-Hype 8	Active Speaker		
LVX 10	Active Speaker	B-Hype 10	Active Speaker		
LVX 12	Active Speaker	B-Hype 12	Active Speaker		
LVX 15	Active Speaker	B-Hype 15	Active Speaker		

OPERA
REEVO

REEVO 210
REEVO 212

dBTechnologies

Quasi 3-way *Active Speakers*

QUASI 3-WAY CONFIGURATION

COAXIAL TRANSDUCERS

2x NEODYMIUM WOOFER

1050 W RMS / 2100 W PEAK

132.5 AND 133 dB MAX SPL

ACOUSTIC PHASE PLUG

FIR FILTERS

3x FLYING POINT

LOW NOISE REFLEX PORT

MADE IN ITALY



dBTechnologies presents two new point-source models within the acclaimed OPERA series, raising the bar and bringing a real revolution at a perfect time, 50 years from the foundation of the company.

Introducing the all-new standard in professional portable sound, made in Italy: OPERA REEVO.

OPERA REEVO 210 and OPERA REEVO 212 deliver an astonishing sound pressure level with touring-grade sound definition and a remarkable low-end extension in a compact and freshly designed enclosure accessible to anybody who wants great sound anywhere.

Quasi 3-way Active Speakers

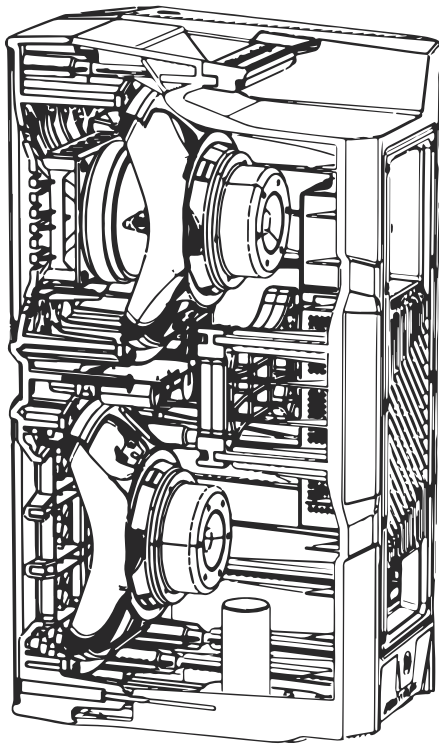

The Quasi 3-way configuration delivers a vigorous yet pristine sound. This bold acoustic design is in-fact unparalleled in its category, inspired by dBTechnologies touring series, marks a clear step-up In the longest running and most appreciated dBTechnologies active speaker series of all times.

Opera Reevo translates the mix in an impeccable way, adapting the speaker to complex musical material especially when rich in the midrange region, where separation and clarity can really make a difference in the outcome of any performance.

This is granted by the coaxial acoustic design, featuring a front Integrated HF horn with diamond-shaped cutouts with the aim of rendering comb filtering-free high frequency reproduction, and at the same time of improving the upper woofer's efficiency.

Another phase plug enhances the lower woofer efficiency: this acoustic device greatly improves the transient response and overall behavior of this transducer.

Low noise reflex ports are integrated in the front molding. The honeycomb structure inside the ports helps reducing wind turbulence caused by the high airflow of this high SPL powerhouse.

Both models are equipped with a Class-D Digipro G2 amplifier which delivers an impressive 1050 W RMS and 2100 W Peak power, and features advanced DSP processing where FIR linear phase filters allow the systems to achieve a coherent audio performance, rendering an uniform and crystal-clear sound. Moreover, Opera Reevo offers factory-tailored voicing presets to adapt to multiple scenarios, including when in need of a wedge stage monitor or a completely standalone full-range PA system.





This versatile sound processing works in tandem with a cleverly designed box shape which combines cutting-edge design and ease of use. OPERA REEVO can be used as a wedge stage monitor or on a classic speaker stand support. When paired with a subwoofer can be mounted on a 36mm standard pole, and can be also suspended thanks to the integrated 3x M10 threaded eyebolts, making this enclosure a perfect permanent installation complement.

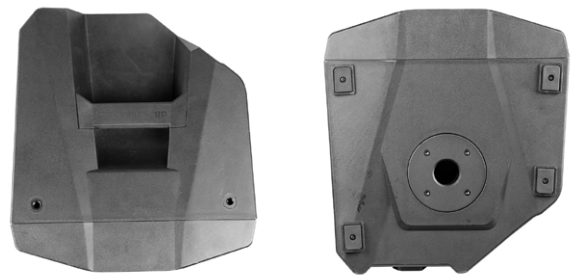

Both cabinets have a very compact size compared to the output SPL of 132.5 dB (REEVO 210) and 133 dB (REEVO 212), yet featuring 2x Neodymium woofers (10" for REEVO 210 and 12" for REEVO 212) and one 1.75" coaxial compression driver, keeping the overall weight down to 17.2 Kg / 37 lbs (REEVO 210) and 20.4 Kg / 44 lbs (REEVO 212).

When it comes down to business, Opera Reevo outstanding voicing ensures seamless and transparent rendition of any speech, where intelligibility is mission critical (such as corporate events or houses of worship) with a very wide nominal dispersion: 100°x80° (REEVO 212) and 100°x90° (REEVO 210) granting greatly consistent coverage from every listening position.



Professional Active Speakers



**OPERA
REEVO 210**



**OPERA
REEVO 212**

Speaker Type	Quasi 3-Way Active Speaker	Quasi 3-Way Active Speaker
Frequency Response [- 10dB]	54 - 19.400 Hz	48 - 20.000 Hz
Frequency Response [- 6dB]	60 - 19.100 Hz	52 - 19.200 Hz
Max SPL	132.5 dB	133 dB
HF	1" Exit CD, 1.75" v.c.	1" Exit CD, 1.75" v.c.
Horizontal Directivity	100°	100°
Vertical Directivity	90°	80°
Horn	Asymmetrical Horn	Asymmetrical Horn
LF	2x 10" Neo, 2.5" v.c.	2x 12" Neo, 2.5" v.c.
Amp Technology	Digipro G2 with SMPS	Digipro G2 with SMPS
Amp Class	Class-D	Class-D
RMS Power	1050 W (525W + 525W)	1050 W (525W + 525W)
Peak Power	2100 W (1050W + 1050W)	2100 W (1050W + 1050W)
Controller	DSP 28/56 bit	DSP 28/56 bit
AD/DA Converter	24 bit / 48 kHz	24 bit / 48 kHz
Crossover Frequency	1260 Hz	1260 Hz
Limiter	Peak, RMS, Thermal	Peak, RMS, Thermal
Advanced DSP Function	Linear Phase FIR filters	Linear Phase FIR filters
Signal Input	1x Combo (XLR-Jack 6.3 mm) MIC/Line	1x Combo (XLR-Jack 6.3 mm) MIC/Line
Signal Output	1x XLR Male (True Link)	1x XLR Male (True Link)
Controls	Gain (rotary) Preset (Flat, Playback, Wedge)	Gain (rotary) Preset (Flat, Playback, Wedge)
Housing	Polypropylene	Polypropylene
Grille	Full grille	Full grille
Handles	1x Side, 1x Top	1x Side, 1x Top
Rigging Points	2x M10 on Top + 1x M10 on Back	2x M10 on Top + 1x M10 on Back
Pole Mount	D36 mm	D36 mm
Angles Up	Monitor use 45°	Monitor use 45°
Width	300 mm (11.81 in)	345 mm (13.58 in)
Height	604 mm (23.78 in)	690 mm (27.17 in)
Depth	324 mm (12.76 in)	376 mm (14.8 in)
Weight	17.2 kg (37 lbs)	20.4 kg (44 lbs)



INGENIA

INGENIA **IG1T**
INGENIA **IG2T**
INGENIA **IG3T**
INGENIA **IG4T**

Professional *Active Speakers*

**CEC HORN TECHNOLOGY
(ASYMMETRICAL VERTICAL COVERAGE)**

DIGITAL STEERING COVERAGE

ELEMENT POSITION DETECTION (IR PORT)

SPEAKERS WITH NEODYMIUM MAGNET

OLED DSP INTERFACE

UNIQUE SPEAKER LOCK SYSTEM

Cutting-edge technology with inspired ideas

The current panorama of active speakers with digital processing offers a significant amount of products with more or less advanced technologies and cutting-edge features. But it's only when those technologies are combined with inspired ideas that products are really able to change the scenario. That's exactly what INGENIA represents: a new synthesis of knowledge in acoustics, mechanics, power electronics, DSP programming and innovative materials combined to realize a simple idea: a range of portable active speakers compact, modular, flyable, with a user-friendly interface, able to recognize the presence of a second stacked speaker or a subwoofer and automatically setup to ensure best coverage, acoustic coherence and high sound pressure.

INGENIA is not a simple active speaker, not a column system, not a conventional line array. INGENIA is simply INGENIA: a new way of thinking about sound reinforcement in any kind of situation.

Professional Active Speakers

INGENIA Series

The INGENIA series consists of four models with a power ranging from 400W to 900W. They are equipped with premium low frequencies transducers: 6.5" for IG1T and IG4T, 8" for IG2T and 10" for IG3T. Compression drivers range from 1" for IG1T and IG2T to 1.4" for IG3T and IG4T.



CEC - Controlled Energy Coverage: new horn concept

The horn of INGENIA is horizontally symmetric and vertically asymmetric. The horizontal dispersion is wide and constant; the vertical dispersion is narrow in the upper part and wide in the lower. This is because the INGENIA speakers are designed to work in single or stacked configuration with the two horns coupled one upon the other by overturning the upper speaker on the lower one.

Digipro® G3 Amp Modules

All models comes with the new generation of exclusive digital amplifiers Digipro® G3, which deliver a power that you can't expect from such a small amplifier. They also features an exceptionally lightweight design, SMPS technology with PSU auto-range and a very remarkably efficiency so that there is no need of cooling fans.

User-Friendly Interface

The INGENIA series is incredibly simple to set up. Just connect the speaker to mains through the new Neutrik® NAC3PX on rear panel, connect the audio using the balanced XLR connectors, select MIC or LINE input, adjust the volume and you're done. Leave everything else to the powerful DSP.

Configuration Wizard

The advanced interface guides the user since he turns on the speaker, asking for information on the use and the type of configuration he is going to use. The system automatically sets up, in order to quickly meet the demand. Of course he can change all the choices made at any time by either restarting the wizard, or manually changing the specific parameter.

The system even allows you to choose from a variety of configurations with one or more INGENIA speakers and combinations with one or more subwoofers, choosing among several dBTechnologies subwoofer presets.

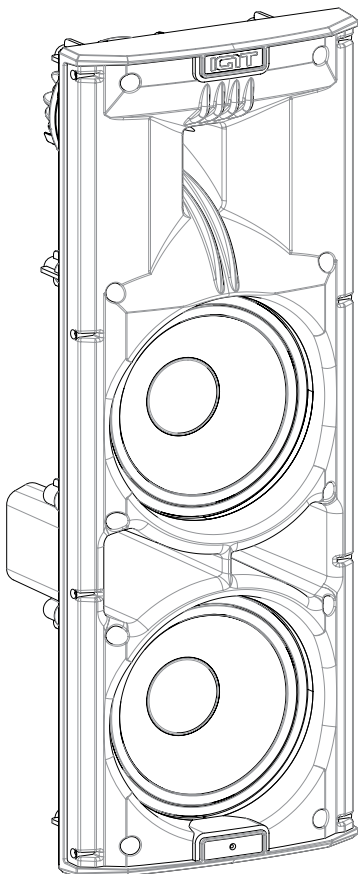

A powerful processing

Behind the simple interface there is a cutting-edge processing, which manages mixer, power amplifiers, coverage steering and customize many other functions such as EQs, levels as well as all input devices. The OLED display, visible even in the sunlight, is mounted behind an elegant smoked screen and provides all the necessary information to the total system control. All editing operations are carried out through a single rotary encoder with switch, making them extremely easy and error-free.

As mentioned above, the INGENIA is equipped with the new Neutrik® NAC3PX mains connector that provides a safe connection with secure locking system. The integrated USB mini port allows the user upgrade the firmware of the INGENIA, ensuring that the speaker is always updated to the latest version (download from www.dbtechnologies.com).

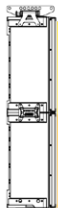

Digital steering coverage

This is not the first time that dBTechnologies R&D designs speakers with asymmetric horns. Even on the famous OPERA series were adopted technical solutions of this type, but now the mechanical design of the waveguide is supported by a sophisticated processing in order to steer the coverage depending on the presence or not of the second speaker. The result is to ensure maximum intelligibility and transparency in the whole frequency range.

EPD

EPD - Element Position Detection

But now some questions arise: how to instruct the DSP of INGENIA that there is a speaker on it, that this speaker is the right one and that is correctly stacked? Infrared technology offers the solution.

Infrared Communication

The INGENIA speakers are equipped with an 'infrared-core handle' on top, which contains a system of infrared communication. When a second INGENIA speaker is stacked on another, there is a quick exchange of information between the two DSPs: the first becomes the master, the second the slave.



Self-rotating display

Since the INGENIA speakers are made to work in 'reversed stacked configuration', the OLED display is equipped with a self-rotation device that feels when the speaker is upside down, ensuring maximum intelligibility in every position, thanks to an integrated accelerometer.

This infrared detection system does not suffer the presence of sunlight, so it can be used safely in any outdoor environment without any lack of communication.

Control Mirroring

When two INGENIAs are used in stacked configuration, the speakers work as a unique system. Volume and DSP processing are unified. In other words, when the user turns the volume up or down on the master speaker, this change will automatically be mirrored on the slave.



Professional Active Speakers

Lightweight and heavy-duty enclosure

The housing is made with a new type of reinforced polypropylene that has a very elegant look and a fine finish. The enclosure surface is then immune to knocks and scratches and fully resistant to water and moisture. Internally, there is an aluminium reinforcing structure that, in addition to dampen vibrations and enhance the acoustic characteristics of the speaker, greatly improves the box toughness. Finally there is a hardware metal reinforcement for the flybar hidden inside the cabinet.

A magnetic rain cover is also available, in order to rapidly protect the speaker from rain, especially in outdoor events, whether the speaker is upright or upside down.

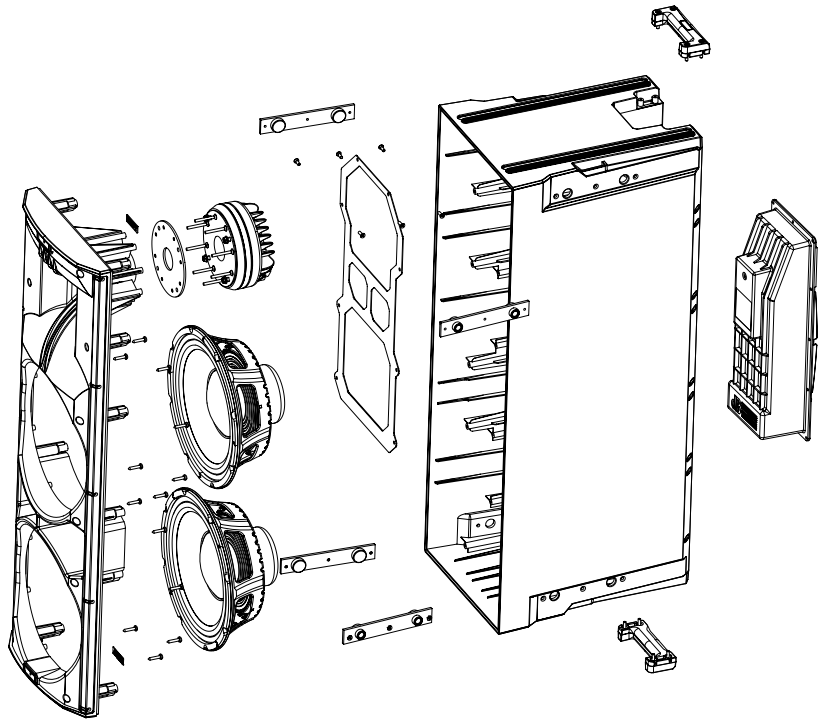

Speakers with neodymium magnet

All transducers in the INGENIA series feature neodymium magnets, improving reliability, performance and contributing to contain the overall weight of these modules. The weights, despite the huge technology contained in these speakers, range from 10.8Kg (23.81lbs.) of IG1T to 20.8Kg (45.86lbs.) of IG3T, making the INGENIA absolutely portable and easy to handle.

Flying configuration

All INGENIA speakers are equipped with a pole-mounting hole (D36mm). But in addition to the use on pole or speaker stand, there is a new flybar (DRK-IG) adaptable to all speakers of the series. This bar allows the user to hang up to two speakers in vertical array. Of course in this case two linking plugs are needed. Then the user will choose the appropriate processing preset and the DSP will set up everything so that you get all benefits of a line source system. Finally there is an additional accessory to mount the flybar to truss couplers and thus locking the aiming even in case of wind.

Unique speaker lock system

The locking system of the INGENIA is extremely rugged and reliable and the LP-IG accessory fits all the 4 INGENIA models. Moreover, to ensure the speakers to be perfectly aligned before locking the clamps, there are some feet and recessions on the top and the bottom of the enclosure. This solution avoids incorrect operations in any way and ensures perfect alignment, maximum safety and a longer life of the mechanical parts.

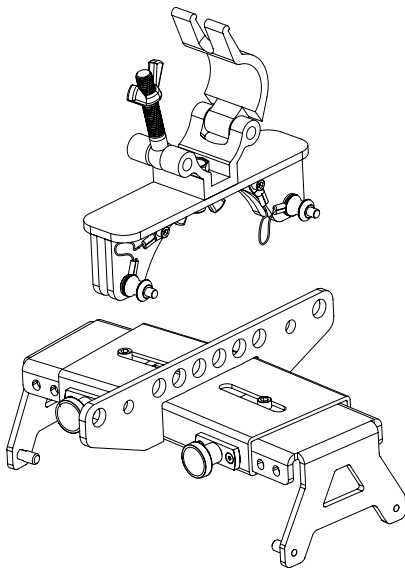

	IG1T	IG2T	IG3T	IG4T
Speaker Type	2-Way Active Speaker	2-Way Active Speaker	2-Way Active Speaker	2-Way Active Speaker
Frequency Response [- 10dB]	85 - 20.000 Hz	59- 20.000 Hz	53 - 20.000 Hz	74- 20.000 Hz
Frequency Response [- 6dB]	92 - 19.200 Hz	63- 19.200 Hz	57- 19.200 Hz	88 - 19.200 Hz
Max SPL	128 dB	128 dB	132 dB	132 dB
HF	1"	1"	1.4"	1.4"
HF voice coil	1.4"	1.4"	3"	3"
Directivity (HxV)	100° x 80° (+15°/- 65°)	100° x 80° (+15°/- 65°)	110° x 90° (+20°/- 70°)	110° x 90° (+20°/- 70°)
HF Type	Neodymium compression driver	Neodymium compression driver	Neodymium compression driver	Neodymium compression driver
Horn	Vertical asymmetric	Vertical asymmetric	Vertical asymmetric	Vertical asymmetric
Crossover Frequency	2100 Hz	1900 Hz	1100 Hz	1100 Hz
LF	2x 6.5"	2x 8"	2x 10"	4x 6.5"
LF voice coil	1.5"	2"	2.5"	1.5"
LF Type	Neodymium	Neodymium	Neodymium	Neodymium
Amp Technology	Digipro® G3	Digipro® G3	Digipro® G3	Digipro® G3
Amp Class	Class-D	Class-D	Class-D	Class-D
RMS Power	400 Watt	400 Watt	900 Watt	900 Watt
Peak Power	800 Watt	800 Watt	1800 Watt	1800 Watt
Controller	DSP 28/56 bit	DSP 28/56 bit	DSP 28/56 bit	DSP 28/56 bit
AD/DA converter	24bit/48kHz	24bit/48kHz	24bit/48kHz	24bit/48kHz
DSP Settings	Acoustic correction, HPF, Anti-feedback filters, delay	Acoustic correction, HPF, Anti-feedback filters, delay	Acoustic correction, HPF, Anti-feedback filters, delay	Acoustic correction, HPF, Anti-feedback filters, delay
Limiter	Dual Active Peak, RMS, Thermal	Dual Active Peak, RMS, Thermal	Dual Active Peak, RMS, Thermal	Dual Active Peak, RMS, Thermal
User Interface	OLED display + rotative knob w/switch	OLED display + rotative knob w/switch	OLED display + rotative knob w/switch	OLED display + rotative knob w/switch
Self-rotating display	Yes	Yes	Yes	Yes
Positioning	EPD (Element Position Detection)	EPD (Element Position Detection)	EPD (Element Position Detection)	EPD (Element Position Detection)
Advanced Features	Yes	Yes	Yes	Yes
Input	1 x Combo (XLR + TRS) 1 x PowerCON TRUE1	1 x Combo (XLR + TRS) 1 x PowerCON TRUE1	1 x Combo (XLR + TRS) 1 x PowerCON TRUE1	1 x Combo (XLR + TRS) 1 x PowerCON TRUE1
Output	1 x XLR link 1 x PowerCON TRUE1	1 x XLR link 1 x PowerCON TRUE1	1 x XLR link 1 x PowerCON TRUE1	1 x XLR link 1 x PowerCON TRUE1
USB connector	mini USB	mini USB	mini USB	mini USB
Housing	Polypropylene PP reinforced	Polypropylene PP reinforced	Polypropylene PP reinforced	Polypropylene PP reinforced
Grille	FULL /Invisible screws	FULL/Invisible screws	FULL/Invisible screws	FULL/Invisible screws
Flyable	Yes	Yes	Yes	Yes
Handles	1x on top / 1x on bottom	1x on top / 1x on bottom	1x on top / 1x on bottom	1x on top / 1x on bottom
Pole Mount	Standard D36mm	Standard D36mm	Standard D36mm	Standard D36mm
Width	195 mm (7.68 in)	228 mm (8.98 in)	280 mm (11.02 in)	195 mm (7.68 in)
Height	536 mm (21.10 in)	646 mm (25.43 in)	806 mm (31.73 in)	956 mm (37.64 in)
Depth	271 mm (10.67 in)	315 mm (12.40 in)	393 mm (15.47 in)	271 mm (10.67 in)
Weight	10.8Kg (23.81 lbs.)	12.8Kg (28.22 lbs.)	20.8Kg (45.86 lbs.)	18.2Kg (40.12 lbs.)

Professional Active Speakers

RDNet-EH

Ingenia Handle for RDNet control

dBTechnologies' INGENIA series reaches its full potential with RDNet-EH. A simple, easy-to-mount accessory adds real-time-control capability to all models of INGENIA series.

In facts, thanks to RDNet-EH, all Ingenia speakers can be remote-controlled via RDNet protocol and Aurora Net software, adding further flexibility and ease of use to one of dBTechnologies' more versatile systems.

RDNet-EH substitutes standard INGENIA's handle and allows both control of a single-element system or a coupled-element system (two stacked Ingenias of the same model).

Users can easily remove standard INGENIA lower handle and replace it with RDNet-EH, which makes the system ready for RDNet connection thanks to built-in data IN and data OUT RJ45 connectors.

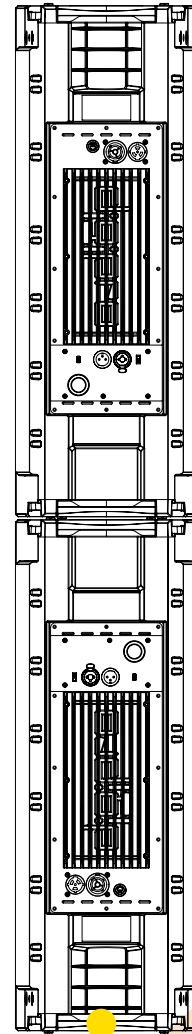

Beside this accessory, you only need a dBTechnologies' RDNet controller (Control 2 or Control 8) and Aurora Net software. This way, you can remotely optimize system's EQ, Delay and even the exclusive Digital Steering function, adapting INGENIA PAs to the venue and application (speech, playback or live music).



es entertainment
system

ES 1203

ES 1002

ES 503

ES 802



Entertainment Systems

ES 1203

TRI-AMPED DIGITAL ACTIVE STEREO SYSTEM

2400 W PEAK POWER

LAST GENERATION DIGIPRO G4 AMP WITH PFC

USER-FRIENDLY DSP INTERFACE

3 CONFIGURATION MODES

(MONO, STEREO OR DOUBLE COLUMN)

ON-BOARD 5 CHANNEL MIXER

BLUETOOTH® AUDIO RECEIVER

DIGITAL STEERING PRESETS (FAR/NEAR)

3 INPUT CHANNEL MODES (MIC/INSTR/LINE)

**CUSTOMIZABLE BALANCED OUTPUT CHANNEL
(LINK OUT/AUXILIARY)**

ULTRA-WIDE COVERAGE



ES is the first dBTechnologies' Entertainment System series: complete plug-and-play column systems, equally multifunctional, portable, space-saving and user-friendly.

ES family grows stronger with ES 1203, a complete stereo sound system encompassing its predecessors' versatility with striking SPLs (the system features a 2400W last-generation power amp) and an impressively coherent throw pattern.

Tri-Amp Entertainment Stereo System

The most powerful complete PA system

ES1203 is a 3-amped stereo sound system composed by 2 passive wooden tops and one active wooden subwoofer equipped with 2x 12" woofers. The sub hosts last-generation Digipro® G4 2400W Peak Amp. A powerful DSP (controlled by an intuitive user interface placed on the top of the sub) manages all function of the 5-channel on-board digital mixer, as well as the system configurations.

Ultra-wide coverage

Each top satellite is equipped with 4x 4" mid-woofers, whose alignment allows an asymmetrical vertical coverage (thanks to the Logarithmic Curved Column Array technology). The unique design of phase plugs widens the horizontal coverage and guarantees a perfect intelligibility. Moreover, on board DSP allows users to choose among 3 Configuration Modes (Mono, Stereo or Double Column) and 3 different Steering Modes (Up/Down/Far). This way, the system adapts to all kind of environments and guarantees the best throw pattern.



ES 1203

Speaker Type	3-amped Stereo System with two full-range tops and one semi-horn loaded subwoofer
Frequency Response [-10dB]	35 - 20.000 Hz
Max SPL	132 dB
MF-HF	8x 4", v.c. 1"
MF-HF Type	Neodymium
LF	2x 12", v.c. 2.5"
LF Type	Ceramic
Directivity [HxV]	97° x 60° (single top)
Amp Technology	Digipro® G4
Amp Class	Class-D
Peak Power	2400 W
Controls	1x OLED Display with rotary encoder w/button 1x Audio signal monitoring LED 1x USB port (service data)
Power Supply	Full-range with PFC
Power Connection	VDE socket
Cooling	Convection
Controller	DSP 28/56 bit
Converter AD/DA	24 bit/48 kHz
Limiter	Peak, RMS, Thermal
Crossover Frequency LF-MF	160 Hz
Digital Steering	Up/Down/Far
Input Channels	1x Mic/Instrument Combo (XLR/Jack) 2x Mic/Line Combo (XLR/Jack) 1x Bluetooth® built-in receiver
Mix Output	1x XLR balanced output
Housing (Subwoofer)	Plywood with full metal grille
Housing (Tops)	Plywood with full metal grille
Pole Mount	Ø36 mm (M20 thread)
Handles	3 (1 on top + 1 each side on sub)
Dimensions WxHxD (Tops)	110x460x160 mm - 4.33x18.11x6.30 in
Dimensions WxHxD (Subwoofer)	360x680x545 mm - 14.17x26.77x21.46 in
Weight (1 Top)	3.3Kg - 7.27lbs.
Weight (Subwoofer)	29.3Kg - 64.59lbs.

Fast-lock top speakers connection

Top satellites can be used separately in a Stereo configuration (placed on tripods or installed with WB-44 accessory) or connected together in a Mono Configuration: the enclosure of the two satellites embeds a metal lock connection system, which assures perfect top-to-top matching without the risk of incorrect assembly and includes the electrical connection between the two tops. One of the two satellites receives the powered signal from the subwoofer through a 4-poles male Speakon™ connector and relaunch the audio to the other top.



On-board 5-channel Mixer

ES1203 features an on board 5 channel mixer: the first channel features a Mic/Instrument balanced/unbalanced combo connector with an adjustable anti-feedback filter, impedance compensation and microphone gain with 3 positions (0, +10, +20dB). The second and third channels are Mic/Line inputs with balanced/ unbalanced combo connector. This allows the system to manage up to 3 mic lines at a time.

The balanced Aux/Mix output can be used as a direct link, or, alternatively, as an Aux output. In this case, you can actually feed a stage monitor or another speaker for which a custom separate mix is needed. When in double column mode, this output acts as a source of a second ES system providing left or right content.



Integrated Stereo Audio Bluetooth® Module

ES1203 is equipped with a built-in Bluetooth® module, which receives stereo audio from devices such as mobile phones, tablets or any other audio device with a Bluetooth® connection. The system manages the Bluetooth® audio autonomously as a separate channel.

User Friendly OLED display

ES1203 is incredibly simple to set up. Users are guided step-by-step to configure the system according to the application thanks to the advanced graphical interface. In fact, the OLED display allows to enter the heart of the system, recall configuration presets, adjust levels, EQ and create a pre/post gain mix for different purposes. A rotary encoder with a switch allows to control any operation easily and quickly.

A Powerful Subwoofer

The semi-horn loaded subwoofer houses 2x 12" woofers and the amp module, and the OLED display with system controls. In addition to the input connectors and controls of the user-interface, there are two Speakon outputs and the power connector. The enclosure, sturdy and stylish, is made of plywood coated with a durable scratchresistant black coat, which makes it truly road-ready. The dolly DO-ES1203 allows to transport the system quickly and smoothly.

Clean and elegant in Mono Mode

When used in Mono mode, the system can be completed with DP-ES1203, a designed wooden pole which levels out the overall design resulting in an elegant, unobtrusive look which perfectly fits permanent installations.

The ES1203 bundle is composed by a subwoofer with its cover, two tops with bag, a D35mm pole, 2 Speakon cables (2.5 mt and 7 mt), power supply cable.

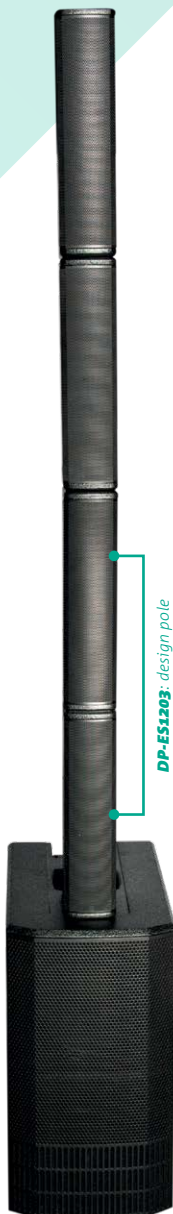

DP-ES1203: design pole

Bi-Amp Entertainment Portable System

ES 1002

BI-AMPED ACTIVE PA SYSTEM

1800W PEAK POWER

1 TOP 8x 4" MID-HI WOOFERS

1 SUB 2x 12" WOOFERS

EXTRA-PRECISE COVERAGE DISPERSION (HORIZONTAL AND VERTICAL)

NEW PHASE-PLUG DESIGN FOR PERFECT INTELLIGIBILITY

2 INDEPENDENT INPUT CHANNELS

ENHANCED USABILITY FOR CONTROL PANEL

8 EQ PRESETS

More power, precise coverage and advanced usability

ES1002 comes with a subwoofer and 1 column top, both powered by a class-D DIGIPRO® G3 amplifier delivering 1800 W peak.

The top satellite is equipped with 8x 4" mid-woofers, whose alignment allows an asymmetrical vertical coverage, avoiding any useless dispersion of the sound above the audience. Moreover, each mid-range woofer is provided with a newly designed phase-plug able to widen the horizontal coverage while guaranteeing a perfect intelligibility of the vocal range from every listening position.



ES 1002

Speaker Type	Bi-amped System with one full-range top and one semi-horn loaded subwoofer
Frequency Response [-10dB]	43 - 20.000 Hz
Max SPL	130.7 dB
MF-HF	8x 4", v.c. 1"
MF-HF Type	Neodymium
LF	2x 12", v.c. 2.5"
LF Type	Ceramic
Directivity [HxV]	97° x 40°
Amp Technology	Digipro® G3
Amp Class	Class-D
Peak Power	1800 W
Controls	DSP rotary encoder, volume control, MIC/LINE Switch
Power Connection	VDE socket
Cooling	Convection
Controller	DSP 28/56 bit
Converter AD/DA	24 bit/48 kHz
System Presets	Flat - Bass boost - Bass reduction - Playback - Speech - Long throw - HPF 80 Hz - HPF 120 Hz
Limiter	Peak, RMS, Thermal
Crossover Frequency LF-MF	160 Hz
Input Channels	1x Mic/Instrument Combo (XLR/Jack) 1 x RCA (stereo)
Mix Output	1x XLR balanced output with aux volume 1x speakon to top
Housing (Subwoofer)	Plywood with full metal grille
Housing (Top)	Plywood with full metal grille
Pole Mount	Ø36 mm (M20 thread)
Handles	3 (1 on top + 1 each side on sub)
Dimensions WxHxD (Top)	110x905x160 mm - 4.33x35.63x6.30 in
Dimensions WxHxD (Subwoofer)	360x680x545 mm - 14.17x26.77x21.46 in
Weight (Top)	5.8 Kg - 12.79 lbs.
Weight (Subwoofer)	29.3Kg - 64.59lbs.

The sub encompasses 2x 12" woofers in bass-reflex configuration, the amp module and the control panel, whose inclined design improves usability. I/O section allows to connect up to 2 INPUTS (XLR mono and RCA stereo with independent volume controls) and provides a balanced link out to feed a second system or a stage monitor. A rotary with 8 preset EQ helps users to perfectly tune the system, adapting it to different environments and uses (playback, live music, speech etc.).

The enclosures of both top and sub are made of plywood, coated with a durable scratch-resistant finish, which makes ES1002 truly road-ready.



Bluetooth®

ES503 is a complete 3-element system which adapts to several uses (and thousands of different users), thanks to a built-in digital mixer, an OLED display user interface and a Bluetooth® audio receiver.

ES503 is a 1000W 3-amped sound system composed by 2 slave 4x 3" full-range tops and 1 master 12" subwoofer. The sub hosts a Digipro® G3 amp module with auto-range PSU and a 3-channels mixer with Bluetooth connection. A powerful DSP manages all function of the onboard digital mixer, making the ES503 a real gem in terms of sound performance and versatility.



ES 503

Speaker Type	3-amped Stereo System with two full-range tops and one subwoofer
Frequency Response [-10dB]	37 - 15.000 Hz
Max SPL	121 dB
MF-HF	8x 3"
MF-HF Type	Neodymium
LF	12"
Directivity [HxV]	95° x 65°
Amp Technology	Digipro® G3
Amp Class	Class-D
Power Amp	1000 W
Controls	1x OLED Display with rotary encoder w/switch 1x Audio signal monitoring LED 1x USB port (service data)
Power Supply	Auto-range SMPS
Power Connection	VDE socket
Cooling	Convection
Controller	DSP 28/56 bit
Converter AD/DA	24 Bit/48 kHz
System Presets	Factory presets + User defined
Limiter	Dual Active, Peak, RMS, Thermal
Crossover Frequency LF-MF	206 Hz
Mic/Instrument Channel	1x Combo (XLR/Jack) balanced/unbalanced input
Line Channels	2x Combo (XLR/Jack) balanced/unbalanced inputs
Media Channel	1x Bluetooth® built-in receiver
Mix Output	1x XLR balanced output
Housing (Subwoofer)	15mm Black Painted Plywood
Housing (Tops)	Polypropylene PP
Handles	2x lateral side (Subwoofer)
Dimensions WxHxD (Tops)	95x360x137 mm - 3.74x13.98x5.39 in
Dimensions WxHxD (Subwoofer)	465x400x430 mm - 18.3x15.7x16.9 in
Weight (1 Top)	1.9Kg - 4.19lbs.
Weight (Subwoofer)	16.4Kg - 36.16lbs.

The ES503 bundle is composed by a subwoofer, two tops, a D25mm pole and a Speakon/Speakon cable to connect the sub to the top. The speaker pole is splittable in two segments for easy transport.

The system also provides a large group of accessories, such as 2 D25mm tripod stands with a dedicated transport bag, a bag to carry 2 tops and a D25mm pole, a bag for the 12" subwoofer, a trolley, a cable kit with two 7m Speakon/Speakon cables. A stereo kit comprising 2 tripods + 2 7m Speakon/Speakon cables and a transport kit comprising 1 sub bag + 1 top bag + 1 trolley are also available.

Bi-Amp Entertainment Portable Systems

ES 802

Great versatility

After the success of the ES503, dBTechnologies complete its Entertainment System series with ES802, a bi-amped system combining power, extremely coherent coverage, excellent acoustic performance, easy transport and set up.

The powerful DSP and the particular flexibility of the inputs also ensure a great versatility. That's why ES series is the perfect solution for performers requiring small-sized plug and play systems providing a lusty acoustic performance.

The satellites have been designed using 4x 3" transducers ensuring a coherent coverage in every environment. The subwoofer houses a 1200 W amplifier and is equipped with a 12" woofer, ensuring a low frequencies consistency which you wouldn't expect from such a compact system.



The powerful DSP of the ES802 system provides 8 configurations, allowing to digitally equalize the audio signal according to different usage needs. The system allows to input both a connection from a mixer (line level) and a microphone connection. The balanced 'LINK' output allows to create bigger ES systems or to feed the mix to any other system.

ES 802

Speaker Type	bi-amped system with two full-range tops and one subwoofer
Frequency Response [-10dB]	35 - 15.000 Hz
Max SPL	124 dB
HF	8x 3"
HF Type	Neodymium Woofers with phase plug
LF	1x 12"
Directivity [HxV]	95° x 65°
Amp Technology	Digipro® G3
Amp Class	Class-D
Power Amp	1200 W
Controls	1x Encoder (8 preset equalisations)
Power Supply	Auto-range SMPS
Power Connection	VDE socket
Cooling	Convection
Controller	DSP 28/56 bit
Converter AD/DA	24 Bit/48 kHz
System Presets	8 Factory presets
Limiter	Dual Active, Peak, RMS, Thermal
Crossover Frequency LF-HF	206 Hz
Mic/Instrument Channel	1x Combo (XLR/Jack) balanced/unbalanced input
Line Channels	1x RCA stereo input
Mix Output	1x XLR balanced output
Housing (Subwoofer)	15mm Black Painted Plywood
Housing (Tops)	Polypropylene PP
Handles	2x lateral side (Subwoofer)
Dimensions WxHxD (Tops)	95x360x137 mm - 3.74x13.98x5.39 in
Dimensions WxHxD (Subwoofer)	465x400x430 mm - 18.3x15.7x16.9 in
Weight (1 Top)	1.9Kg - 4.19lbs.
Weight (Subwoofer)	16.4Kg - 36.16lbs.

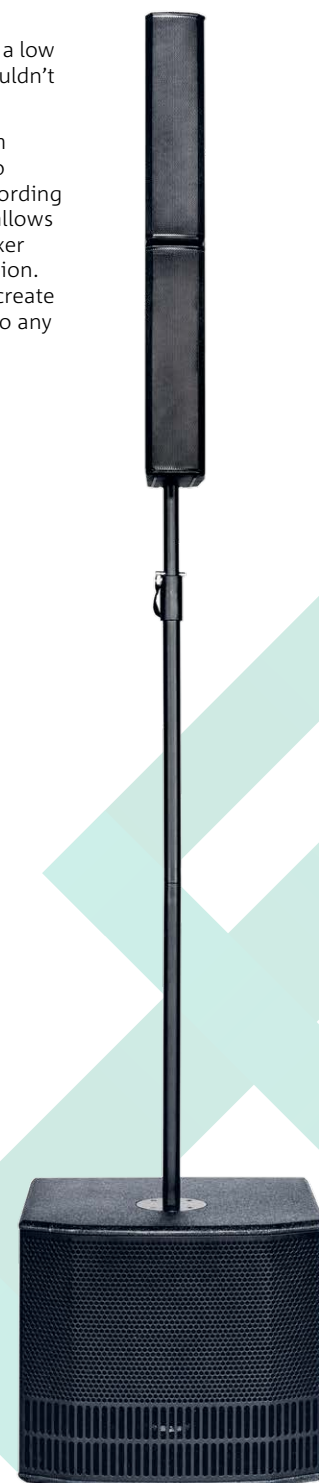



LVX 8
LVX 10
LVX 12
LVX 15

Professional Digital *Active Speakers*



Excellent pedigree. Fit for every time

LVX active loudspeakers series is the answer to all those fixed installations and live music requirements where sound reinforcement systems must be lightweight, stylish, portable, powerful and in line with the highest professional standards. Coming from the experience gained in designing touring products as the renowned DVX series, the new LVX series offers smart solutions with a special attention to the needs of fixed and portable installations.

Advanced Technology

The LVX series uses DIGIPRO® series digital amplifiers with powers ranging from 400W (LVX 8 and 10) to 800W PRG (LVX 12 and 15). These highly efficient amplifiers provide high power, limited weight and are totally silent due to the low thermal dissipation and no cooling fans required.

The digital preamp with DSP controls audio crossover, frequency response, dual active peak-RMS-thermal limiter, and acoustic alignment. A selector enables to select one of two different equalizations - "FLAT" or "PROCESSED" - to provide the right sound in any occasion.

Elegance yet strength

The enclosure is made of robust 12mm plywood with a look very elegant and refined, available in both black and white. All models are equipped with handles for easy transport. The LVX 8 and 10 have a single handle on top; the LVX 12 and 15, in addition to the handle on the top, have a pair of handles on sides. In case of installation where you want to keep as much as possible a stylish and sober look, the white installation version of all the four models comes without the pole mount cup and the handles, providing a very transparent look.

A D36mm pole mount cup on the bottom (black version only) allows all LVX speakers to be placed on poles or tripods, so as to be used as portable sound systems for any live music applications.



Digital Active Speakers

Impeccable Sound

The voicing of these speakers is very linear and designed to for any audio content, such as speech, background or live music, multimedia contents, etc., respecting their characteristics and dynamic response, and with a high level of performance. Four models available: LVX 8, 10, 12 and 15.

The dispersion of the constant directivity horn is symmetric and rotatable in order to keep the same coverage in case of horizontal use. This is particularly valued even in case of use as a stage monitor, configuration possible thanks to the rear angle of 45°.



Versatility at its maximum level

There are two types of wall-mounting brackets: one for vertical installation, especially studied for live applications or truss mounting, with variable pan-tilt options (a pole mount cup is included as a stand adapter). The second is suggested for horizontal permanent installations, where you can easily change tilt position.



	LVX 8	LVX 10	LVX 12	LVX 15
Speaker Type	2-Way Active Speaker	2-Way Active Speaker	2-Way Active Speaker	2-Way Active Speaker
Frequency Response [- 10dB]	65 - 20.000 Hz	60 - 20.000 Hz	55 - 20.000 Hz	49 - 20.000 Hz
Frequency Response [- 6dB]	80 - 19.000 Hz	70 - 19.000 Hz	62 - 19.000 Hz	54 - 19.000 Hz
Max SPL	121 dB	125 dB	127 dB	128 dB
HF	1", 1.5" v.c.	1", 1.5" v.c.	1", 1.5" v.c.	1", 1.5" v.c.
Directivity	90° x 70°	90° x 70°	90° x 40°	90° x 40°
Horn	Rotatable CD Horn	Rotatable CD Horn	Rotatable CD Horn	Rotatable CD Horn
LF	8", 1.5" v.c.	10", 2" v.c.	12", 2" v.c.	15", 2" v.c.
Amp Technology	Digipro® G2	Digipro® G2	Digipro® G2	Digipro® G2
Amp Class	Class-D	Class-D	Class-D	Class-D
PRG Power	400 W	400 W	800 W	800 W
Peak Power	800 W	800 W	1600 W	1600 W
Controller	DSP 28/56 bit	DSP 28/56 bit	DSP 28/56 bit	DSP 28/56 bit
AD/DA Converter	24bit/48kHz	24bit/48kHz	24bit/48kHz	24bit/48kHz
System Presets	Flat, Processed	Flat, Processed	Flat, Processed	Flat, Processed
Limiter	Dual Active Peak, RMS, Thermal	Dual Active Peak, RMS, Thermal	Dual Active Peak, RMS, Thermal	Dual Active Peak, RMS, Thermal
Crossover Frequency LF-HF	2050 Hz	2050 Hz	1800 Hz	1800 Hz
Slope MF-HF	24 dB/Octave	24 dB/Octave	24 dB/Octave	24 dB/Octave
Housing	Multiplex	Multiplex	Multiplex	Multiplex
Angles Up	Monitor use 40°	Monitor use 40°	Monitor use 45°	Monitor use 45°
Handles	1x top side, recessed	1x top side	3 (1x top side, 1x side)	3 (1x top side, 1x side)
Rigging points	10 x M8	12 x M8	12 x M10	12 x M10
Pole mount	D36 mm	D36 mm	D36 mm	D36 mm
Width	260 mm (10.24 in)	300 mm (11.8 in)	360 mm (14.17 in)	430 mm (16.93 in)
Height	420 mm (16.54 in)	480 mm (18.9 in)	610 mm (24 in)	680 mm (26.77 in)
Depth	260 mm (10.24 in)	300 mm (11.8 in)	360 mm (14.17 in)	430 mm (16.93 in)
Weight	10.1 kg (22.27 lbs)	13.5 kg (29.76 lbs)	17 kg (37.5 lbs)	20.7 kg (45.64 lbs)

FLEXSYS
FMX

FLEXSYS **FMX10**

FLEXSYS **FMX12**

FLEXSYS **FMX15**

Coaxial Active *Stage Monitors*

ACTIVE 2-WAY STAGE MONITOR

COAXIAL CONFIGURATION

LINEAR PHASE FIR FILTERS

ULTRA-PRECISE DIRECTIVITY

ROTATABLE HORN (90°x60° OR 60°x90° DISPERSION)

FRONT-REAR GRILLE DESIGN

INTEGRATED HANDLE ON BOTTOM SIDE



Coaxial Active Stage Monitors

Active Coaxial Stage Monitors

A new generation for flagship wedge Flexsys; FMX series encompasses a range of tailored monitoring solutions featuring coaxial design, precise dispersion pattern, last-generation sound processing with linear phase FIR Filters and maximum adaptability to the needs of every performer.

FMX is an active 2-way coaxial stage monitor series available in 3 models (10", 12" and 15") equipped with 800 Peak (for FMX 10) or 1200 Peak (for FMX 12 and 15) Class D amplifiers.

The wedge's coaxial acoustic design, together with its custom horn design and its advanced DSP featuring linear phase FIR filters, provides an even, highly-intelligible sound.

In fact, FMX's horn design allows a very precise dispersion pattern (60° horizontal and 90° vertical) which can be easily reversed (90° horizontal and 60° vertical) by rotating the horn, adapting the wedge to the habits of the user.

Moreover, 8 on-board presets optimize EQ for different needs making FMX a skilfull yet easy-to-use tool for performers of every kind.

All wedges of the series feature a peculiar front-rear grille design, a single handle integrated on the bottom side of the plywood cabinet and a 36mm pole mount on side panel which further enhance FMX's versatility.



	FLEXSYS FMX10	FLEXSYS FMX12	FLEXSYS FMX15
Speaker Type	2-Way Active Coaxial Stage Monitor	2-Way Active Coaxial Stage Monitor	2-Way Active Coaxial Stage Monitor
Frequency Response [-10dB]	57 - 19.000 Hz	52 - 19.000 Hz	46 - 19.000 Hz
Max SPL	125 dB	128 dB	128 dB
HF	1"	1"	1"
HF voice coil	1"	1.3"	1.3"
Directivity	60° x 90°	60° x 90°	60° x 90°
Horn	rotatable	rotatable	rotatable
LF	10"	12"	15"
LF voice coil	2"	2"	2"
Amp Class	Class-D	Class-D	Class-D
Peak Power	800 W	1200 W	1200 W
Controller	DSP 28/56 bit	DSP 28/56 Bit	DSP 28/56 Bit
AD/DA Converter	24bit/48kHz	24bit/48kHz	24bit/48kHz
System Presets	8 presets	8 presets	8 presets
Limiter	Peak, Thermal, RMS	Peak, Thermal, RMS	Peak, Thermal, RMS
Advanced DSP Function	FIR Filters	FIR Filters	FIR Filters
Crossover Frequency	1800 Hz	1740 Hz	1740 Hz
Slope LF-HF	24dB/oct	24dB/oct	24dB/oct
Housing	Plywood	Plywood	Plywood
Housing Design	Multifunctional	Multifunctional	Multifunctional
Handles	1 integrated on bottom side	1 integrated on bottom side	1 integrated on bottom side
Pole mount	Ø 36 mm	Ø 36 mm	Ø 36 mm
Width	390 mm (15.35 in)	465 mm (18.30 in)	500 mm (19.68 in)
Height	268 mm (10.55 in)	297 mm (11.69 in)	340 mm (13.38 in)
Depth	411 mm (16.18 in)	444 mm (17.48 in)	500 mm (19.68 in)
Weight	11.3 kg (24.9 lbs)	13.9 kg (30.6 lbs)	16.9 kg (37.2 lbs)

OPERA

OPERA 10

OPERA 12

OPERA 15

Professional Active Speakers

1200 W PEAK POWER

NEWLY DESIGNED ASYMMETRICAL HORN

ADVANCED DSP WITH FIR PROCESSING

2 INPUT CHANNELS (MIC-LINE/MIC-INSTR)

SELECTABLE OUTPUT CHANNEL (LINK CH1/MIX CH 1+2)

8 EQ PRESETS



Being for many years dBTechnologies' flagship, the celebrated Opera series left a powerful footprint in sound reinforcement history. Now dBTechnologies makes the history evolve, getting back to basics with these three brand new 10", 12" and 15" professional powered speakers.

Exceptional power and a unique acoustic design combined in order to deliver a vigorous yet pristine sound, successfully adaptable to both playback and live music applications. With new OPERA series, dBTechnologies succeeded once again in packing leading edge DSP processing, advanced design features and user friendliness in an unrivalled cabinet in its price range.

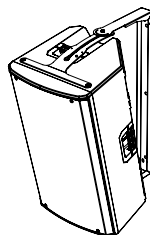

Unrivalled power and design at the service of performers

Opera's asymmetrical horn, which dramatically contributed to the success of the series, has been completely redesigned in order to obtain both an asymmetrical vertical dispersion and a double horizontal dispersion, ensuring an optimized throw pattern.

All 3 models of the series are equipped with a powerful Class D 600 W amplifier featuring advanced DSP processing where FIR filters allow the systems to deliver a coherent audio performance, uniform and crystal-clear from every listening position, thanks to an extremely flat phase response.

Professional Active Speakers



A stellar audio performance sets the stage for success

All models features 2 input channels (allowing live performers to use the system both for vocals and instruments or vocals and playback music), 2 selectable output channels (LINK CH 1 or MIX CH 1+2) and 8 preset equalizations which adapts to the most different environments, making OPERA the perfect companion for the discerning performer.

The new functional yet polished design features a full grille, a top and a side handle easing monitoring purposes. The cabinet comes with an integrated pole mount cup allowing stacked configurations with dBTechnologies bass bins.



	OPERA 10	OPERA 12	OPERA 15
Speaker Type	2-Way Active Speaker	2-Way Active Speaker	2-Way Active Speaker
Frequency Response [- 10dB]	58 - 20.000 Hz	52 - 20.000 Hz	50 - 20.000 Hz
Max SPL	128 dB	129 dB	130 dB
HF	1" Exit, 1.4" v.c.	1" Exit, 1.4" v.c.	1" Exit, 1.4" v.c.
Type HF	Compression driver	Compression driver	Compression driver
Horizontal Directivity	110° (85° up / 120° down)	110° (85° up / 120° down)	110° (85° up / 120° down)
Vertical Directivity	85° (+25° / -60°)	85° (+25° / -60°)	85° (+25° / -60°)
Horn	Asymmetrical Horn	Asymmetrical Horn	Asymmetrical Horn
LF	10", 2" v.c.	12", 2" v.c.	15", 2" v.c.
Amp Technology	SMPS dual range	SMPS dual range	SMPS dual range
Amp Class	Class-D	Class-D	Class-D
RMS Power	600 W	600 W	600 W
Peak Power	1200 W	1200 W	1200 W
Controller	DSP 28/56 bit	DSP 28/56 bit	DSP 28/56 bit
AD/DA Converter	24 bit / 48 kHz	24 bit / 48 kHz	24 bit / 48 kHz
System Presets	Rotary Encoder (8 presets)	Rotary Encoder (8 presets)	Rotary Encoder (8 presets)
Crossover Frequency	2000 Hz	2000 Hz	2000 Hz
Limiter	Peak, RMS, Thermal	Peak, RMS, Thermal	Peak, RMS, Thermal
Advanced DSP Function	Linear Phase FIR filters	Linear Phase FIR filters	Linear Phase FIR filters
Signal Input	1x Combo (XLR-Jack 6.3 mm) MIC/Line 1x Combo (XLR-Jack 6.3 mm) MIC/Inst	1x Combo (XLR-Jack 6.3 mm) MIC/Line 1x Combo (XLR-Jack 6.3 mm) MIC/Inst	1x Combo (XLR-Jack 6.3 mm) MIC/Line 1x Combo (XLR-Jack 6.3 mm) MIC/Inst
Signal Output	1x XLR Male (Ch1 Link/Mix OUT) Selectable	1x XLR Male (Ch1 Link/Mix OUT) Selectable	1x XLR Male (Ch1 Link/Mix OUT) Selectable
Housing	Polypropylene	Polypropylene with Internal Frame	Polypropylene with Internal Frame
Grille	Full grille	Full grille	Full grille
Handles	1x Side, 1x Top	1x Side, 1x Top	1x Side, 1x Top
Rigging Points	2x M10 on Top + 1x M10 on Back	2x M10 on Top + 1x M10 on Back	2x M10 on Top + 1x M10 on Back
Pole Mount	D36 mm	D36 mm	D36 mm
Angles Up	Monitor use 45°	Monitor use 45°	Monitor use 45°
Width	300 mm (11.81 in)	350 mm (13.78 in)	420 mm (16.54 in)
Height	552 mm (21.73 in)	642 mm (25.28 in)	722 mm (28.43 in)
Depth	301 mm (11.85 in)	349 mm (13.74 in)	419 mm (16.50 in)
Weight	12.3 kg (27.12 lbs.)	14.3 kg (31.53 lbs.)	18.3 kg (40.34 lbs.)

KL Series

KL 10
KL 12
KL 15

Bluetooth® *Active Speakers*



BLUETOOTH® CONNECTION

3 CHANNEL IN

1 LINK OUT WITH LINK/MIX SWITCH

ADVANCED DSP WITH FIR PROCESSING

DSP PRESETS FOR WIDE VERSATILITY

SOFT COVER INCLUDED



Bluetooth® Active Speakers



KL series aims to enhance usability and versatility in dBTechnologies' 2-way active speaker series: combining efficiency to a professional sound performance, KL systems feature Bluetooth® connection, 3 INPUT channels, impressive SPLs and a powerful DSP where linear phase FIR filters ensure the most accurate sound reproduction.

KL family is comprised of 3 models, respectively equipped with 10", 12" and 15" woofers and 1" compression driver. The system is driven by a powerful and efficient amplifier (400 W for KL 10 and 800 W* for KL 12 and 15) featuring dBTechnologies' advanced DSP processing where linear phase FIR filters allow the systems to deliver a coherent audio performance, uniform and crystal-clear from every listening position. Moreover, users are enabled to enhance lower and upper frequencies with the convenient DSP preset function.

All cabinets feature 3 INPUT channels with independent level management: CH1 is a balanced combo XLR/6.3 mm Jack line/mic INPUT with a switch to select source; CH2 is a balanced XLR and TRS jack IN; CH3 allows to connect any device via Bluetooth® connection. A balanced link XLR-M Output allows connection to a second loudspeaker or a mixer. A slide switch allow to select which signal is sent to the main output: LINK (the signal is taken before any level control) MIX (the signal is determined by the level control of each channel and Main).

The solid and versatile cabinets come with a clean and contemporary full grille design, enhancing both portability thanks to 3 integrated handles (1x side and 1 on top) and multifunctionality: each cabinet can be used horizontally as a stage monitor (on both sides) and features a pole mount cup with 2 tilt angle options (0° and 7.5°) to use KLs on tripods or stacked on dBTechnologies Subs. KL comes with its soft cover equipped with a pocket specially designed for cables storage.



	KL 10	KL 12	KL 15
Speaker Type	2-Way Active Speaker	2-Way Active Speaker	2-Way Active Speaker
Frequency Response [- 10dB]	55 - 18.000 Hz	52 - 18.000 Hz	48 - 18.000 Hz
Max SPL	125 dB	127 dB	128 dB
HF	1" CD, 1" v.c.	1" CD, 1.35" v.c.	1" CD, 1.35" v.c.
LF	10", 2" v.c.	12", 2.5" v.c.	15", 2.5" v.c.
Dispersion	90° x 60°	90° x 60°	90° x 60°
Crossover Frequency	2000 Hz (24 dB/oct.)	1800 Hz (24 dB/oct.)	1800 Hz (24 dB/oct.)
Amp Technology	Class-D (LF) + Class AB (HF)	Class-D (LF) + Class AB (HF)	Class-D (LF) + Class AB (HF)
Peak Power (LF+HF)	400 Watt	800 Watt*	800 Watt*
Controls	1x Volume 1x slide switch mic/line	1x Volume 1x slide switch mic/line	1x Volume 1x slide switch mic/line
Indicators	power on/signal/limiter LEDs	power on/signal/limiter LEDs	power on/signal/limiter LEDs
Controller	DSP 28/56 bit	DSP 28/56 bit	DSP 28/56 bit
AD/DA Converter	24 bit / 48 kHz	24 bit / 48 kHz	24 bit / 48 kHz
System Presets	Playback, Flat, Bass Boost, Wedge	Playback, Flat, Bass Boost, Wedge	Playback, Flat, Bass Boost, Wedge
Limiter	Peak, RMS, Limiter	Peak, RMS, Limiter	Peak, RMS, Limiter
Advanced DSP Function	Linear Phase FIR filters	Linear Phase FIR filters	Linear Phase FIR filters
Signal Input	1x Combo (XLR/Jack) MIC/Line 1x XLR / TRS	1x Combo (XLR/Jack) MIC/Line 1x XLR / TRS	1x Combo (XLR/Jack) MIC/Line 1x XLR / TRS
Bluetooth® Input	1x Bluetooth® receiver	1x Bluetooth® receiver	1x Bluetooth® receiver
Signal Output	1x XLR Male (Link/MIX)	1x XLR Male (Link/MIX)	1x XLR Male (Link/MIX)
Housing	Polypropylene PP	Polypropylene PP	Polypropylene PP
Handles	3 (2 on sides, 1 on top)	3 (2 on sides, 1 on top)	3 (2 on sides, 1 on top)
Angles Up	Monitor use 40°	Monitor use 45°	Monitor use 45°
Pole Mount	Ø36 mm, double positioning	Ø36 mm, double positioning	Ø36 mm, double positioning
Width	310 mm (12.2 in)	365 mm (14.37 in)	430 mm (16.92 in)
Height	521 mm (20.51 in)	622 mm (24.50 in)	722 mm (28.44 in)
Depth	292 mm (11.51 in)	342 mm (13.46 in)	402 mm (15.82 in)
Weight	11.7 kg (25.79 lbs.)	16.5 kg (36.37 lbs.)	19.3 kg (42.54 lbs.)

*component maximum power handling



B-Hype **8**

B-Hype **10**

B-Hype **12**

B-Hype **15**

2-Way Active *Speakers*

MAXIMUM EFFICIENCY UP TO 126.5 dB SPL

INNOVATIVE HORN DESIGN FOR UNIFORM AND EXTENDED COVERAGE

COMPACT FEATHERWEIGHT

CLEAN AND CONTEMPORARY DESIGN ENHANCING PORTABILITY

3 HANDLES

DOUBLE STAGE MONITOR ANGLE

PRESET EQ FLAT / BOOST



2-Way Active Speakers



Maximum amp efficiency for an assertive SPL

B·Hype series aims to provide a professional sonic performance to all kind of users, combining an extremely efficient CLASS D amplifier with aggressive sound pressure levels while delivering the most accurate sound reproduction.

Faithful and loud

The internal acoustic design features an innovative asymmetrical horn ensuring a uniform throw pattern. What's more, dBTechnologies team crafted an accurate digital sound processing, allowing users to choose between 2 preset EQ: FLAT or BOOST. This way, all B·Hype models deliver the most faithful sound performance while boosting any background music.

Sharp design and enhanced portability

B·Hype's featherweight cabinets (from 14 to 38 lbs) come with a clean and contemporary full grille design, enhancing both portability (3 handles, 1x side and 1 on top) and multifunctionality. Each cabinet can be used horizontally as a stage



monitor (on both sides) and features a pole mount cup in order to be used on tripods or stacked on dBTechnologies Subs.

B·HYPE 8 B·HYPE 10 B·HYPE 12 B·HYPE 15

Speaker Type	2-Way Active Speaker	2-Way Active Speaker	2-Way Active Speaker	2-Way Active Speaker
Frequency Response [- 10dB]	65 - 20.000 Hz	55 - 20.000 Hz	55 - 20.000 Hz	51 - 20.000 Hz
Frequency Response [- 6dB]	70 - 19.600 Hz	70 - 19.600 Hz	61 - 19.500 Hz	57 - 19.700 Hz
Max SPL	120 dB	121 dB	126 dB	126.5 dB
HF	1" CD, 1" v.c.	1" CD, 1" v.c.	1" CD, 1" v.c.	1" CD, 1" v.c.
LF	8", 1.5" v.c.	10", 1.5" v.c.	12", 2" v.c.	15", 2" v.c.
Horizontal Dispersion	asymmetrical 85° up / 120° down	asymmetrical 85° up / 120° down	asymmetrical 85° up / 120° down	asymmetrical 85° up / 120° down
Vertical Dispersion	85° (+25°/-60°)	85° (+25°/-60°)	85° (+25°/-60°)	85° (+25°/-60°)
Crossover Frequency	2300 Hz (24 dB/oct.)	2300 Hz (24 dB/oct.)	2100 Hz (24 dB/oct.)	2100 Hz (24 dB/oct.)
Amp Technology	Class-D	Class-D	Class-D	Class-D
Peak Power	260 Watt	260 Watt	400 Watt	400 Watt
Controller	DSP 28/56 bit	DSP 28/56 bit	DSP 28/56 bit	DSP 28/56 bit
AD/DA Converter	24 bit / 48 kHz	24 bit / 48 kHz	24 bit / 48 kHz	24 bit / 48 kHz
System Presets	Flat, Processed	Flat, Processed	Flat, Processed	Flat, Processed
Limiter	Peak, RMS, Thermal	Peak, RMS, Thermal	Peak, RMS, Thermal	Peak, RMS, Thermal
Housing	Polypropylene PP	Polypropylene PP	Polypropylene PP	Polypropylene PP
Handles	3 (2 on sides, 1 on top)	3 (2 on sides, 1 on top)	3 (2 on sides, 1 on top)	3 (2 on sides, 1 on top)
Angles Up	Monitor use 45°	Monitor use 45°	Monitor use 45°	Monitor use 45°
Pole Mount	Ø36 mm	Ø36 mm	Ø36 mm	Ø36 mm
Width	243 mm (9.57 in)	295 mm (11.61 in)	350 mm (13.77 in)	415 mm (16.34 in)
Height	443 mm (17.44 in)	544 mm (21.42 in)	645 mm (25.40 in)	725 mm (28.54 in)
Depth	231 mm (9.09 in)	283 mm (11.14 in)	330 mm (12.99 in)	391 mm (15.39 in)
Weight	6.6 kg (14.55 lbs.)	9 kg (19.84 lbs.)	13.9 kg (30.46 lbs.)	17.4 kg (38.36 lbs.)

SUB

SUB 915

SUB 918

SUB 612

SUB 615

SUB 618

Active Subwoofers

SUB 915 & SUB 918

ACTIVE BASS-REFLEX SUBWOOFERS

900W RMS DIGIPRO G3 AMP

UP TO 134 dB SPL

REAL TIME CONTROL VIA RDNET

ON-BOARD DELAY CONTROL

ON-BOARD CROSSOVER POINT CONTROL

DESIGNED TO WORK VERTICALLY OR HORIZONTALLY

INTEGRATED TOP-EDGE HANDLES

2x M20 THREADS ON TOP AND SIDE



Active Subwoofers

Complete control of low end power

Designed for ground stacked applications, SUB 900 is the perfect choice whenever a powerful lower extension is required.

Indeed, both models of the series are equipped with high-performance components housed into a bass reflex design and a CLASS D 900 W RMS amplifier.

This is why these cabinets ensures a deep, full-bodied sound in every kind of applications.

SUB 900 are equipped with a single premium woofer (15" for SUB 915 and 18" for SUB 918). A 900 W RMS Class D Digipro G3 power amplifier ensures advanced efficiency as well as forcible sound pressure levels (up to 134 dB for SUB 918).

Not only, thanks to networking capability, users are allowed to complete control of low end frequencies of their PAs. In facts, dBTechnologies' SUB 900 are ready for full remote control via RDNet and software Aurora Net.



SUB 915

SUB 918

Speaker Type	Active Subwoofer	Active Subwoofer
Frequency Response [- 10dB]	45 to Cut Frequency (Xover dependent)	42 to Cut Frequency (Xover dependent)
Max SPL	133 dB	134 dB
LF	15"	18"
LF voice coil	4"	4"
Amp Technology	Digipro G3®	Digipro G3®
Amp Class	Class-D	Class-D
Peak Power	1800 W	1800 W
Controller	DSP 28/56 bit	DSP 28/56 bit
AD/DA Converters	24 bit/48 kHz	24 bit/48 kHz
Limiters	Peak, Thermal, RMS	Peak, Thermal, RMS
Crossover Frequency	Variable (70Hz - 80Hz - 90Hz - 100Hz - 110Hz)	Variable (70Hz - 80Hz - 90Hz - 100Hz - 110Hz)
Controls	1x Subwoofer Attenuation Control 1x Delay Rotary 1x Xover Rotary 1x Polarity switch	1x Subwoofer Attenuation Control 1x Delay Rotary 1x Xover Rotary 1x Polarity switch
Signal Input	1x XLR Female 1x RJ45 Link (RDNet) 1x USB (data service)	1x XLR Female 1x RJ45 Link (RDNet) 1x USB (data service)
Signal Output	1x XLR Male 1x RJ45 Link (RDNet)	1x XLR Male 1x RJ45 Link (RDNet)
Housing	Plywood	Plywood
Handles	2 (1x side)	2 (1x side)
Pole mount	2x M20 (1 on top + 1 on side)	2x M20 (1 on top + 1 on side)
Width	620 mm (24.4 in)	720 mm (28.3 in)
Height	457 mm (17.9 in)	530 mm (20.8 in)
Depth	620 mm (24.4 in)	690 mm (27.1 in)
Weight	34.8 kg (76.7 lbs.)	41.8 kg (92.1 lbs.)

SUB



RDNet remote control

First in dBTechnologies' SUB series, both SUB 915 and SUB 918 are enabled for real time monitoring and remote control via RDNet protocol and Aurora Net software, allowing advanced subwoofer configurations and with perfect low-end matches with dBTechnologies' full-range systems enabled to RDNet communications.

Both models of the family also feature on-board controls for attenuation, a polarity switch and DSP controls for a delay up to 4.5 milliseconds with 0.5 milliseconds steps (while a maximum 21 ms delay is allowed via Aurora Net). A second rotary allows to set crossover frequency from 70 to 110 Hz.

Compact and sturdy cabinet

The robust plywood cabinet encases high-end performances in limited weight (34.8 kg for SUB915 and 41.8 kg for SUB918) and features 2 integrated handles on the top edges, while the back side is equipped with wheels mounting for smooth transportation.

What is more, being designed for both vertical or horizontal use, 2 M20 mounts on the top and side panels allow to mount on the sub any full-range speaker using a standard M20 threaded pole.

SUB 612, 615 & 618

1200 W PEAK CLASS D AMP

STEREO OR MONO BALANCED INPUT

LINK OR X-OVER BALANCED STEREO OUTPUT MODE

COMPACT AND STURDY WOOD CABINET

LIGHTWEIGHT

POLARITY SWITCH

FLAT OR BOOST MODE SWITCH



Active Subwoofers



Low end precision

SUB 600 series has been designed to create complete PA systems making the most of dBTechnologies portable full range systems.

Able to deliver outstanding sound pressure levels in spite of their compact housing, SUB 600s provide a clean, impressively precise low-end reproduction. All models features a 600W RMS Class D Power Amplifier with SMPS and are equipped with respectively 12", 15" or 18" premium transducers.

Sub 600s' remarkable audio performance allows users to build most of the PA systems with 1 single sub and 2 full range speakers, avoiding any external processing or crossover thanks to a balanced Xover signal to left and right

speakers. Controls on the amp panel allow user to operate with Mono or Stereo audio feed, activate polarity inversion and choose Outputs link mode (True Bypass or Xover). Whenever a further punch is needed, a low-frequencies boost EQ can be set thanks to the Sub Mode switch.

The series comes with a full grille design in a lightweight wood cabinet strengthened with a hardwearing, scratch-resistant black covering. Carved side handles enhance portability. The design of the top side eases subs stacking in larger systems and features a M20 pole mount thread to stack full-range speakers.



	SUB 612	SUB 615	SUB 618
Speaker Type	Active Bass-reflex Subwoofer	Active Bass-reflex Subwoofer	Active Bass-reflex Subwoofer
Frequency Response [-10dB]	46 - 123 Hz	42 - 124 Hz	35 - 130 Hz
Max SPL	129 dB	131 dB	133 dB
Directivity	Omnidirectional	Omnidirectional	Omnidirectional
LF	12"	15"	18"
LF voice coil	1.5"	2.5"	2.5"
Amp Technology	SMPS digital amplifier	SMPS digital amplifier	SMPS digital amplifier
Amp Class	Class-D	Class-D	Class-D
Peak Power	1200 W	1200 W	1200 W
Controller	28/56 bit DSP	28/56 bit DSP	28/56 bit DSP
Limiters	Peak, Thermal, RMS	Peak, Thermal, RMS	Peak, Thermal, RMS
Controls	Subwoofer level, Outputs mode, Polarity, Subwoofer mode	Subwoofer level, Outputs mode, Polarity, Subwoofer mode	Subwoofer level, Outputs mode, Polarity, Subwoofer mode
Signal Input	2x XLR	2x XLR	2x XLR
Signal Output	2x XLR	2x XLR	2x XLR
Housing	Plywood	Plywood	Plywood
Handles	1 on top	2 (1x side)	2 (1x side)
Pole mount	D36 mm on top	D36 mm on top	D36 mm on top
Width	360 mm (14.72 in)	430 mm (16.92 in)	500 mm (19.69 in)
Height	550 mm (21.65 in)	580 mm (22.83 in)	625 mm (24.60 in)
Depth	525 mm (20.67 in)	600 mm (23.62 in)	690 mm (27.17 in)
Weight	19.8 kg (43.65 lbs.)	25.5 kg (56.22 lbs)	31.1 kg (68.57 lbs)

MINIBOX

MINIBOX **L160D**
MINIBOX **K300**
MINIBOX **K162**
MINIBOX **K70**

Compact Active Speakers



MINIBOX **L160D**

Speaker Type	2-Way Active Speaker
Freq. Response [- 10dB]	70 - 20.000 Hz
Max SPL	116 dB
HF	1"
Type HF	Dome tweeter, coaxial
Directivity	85° x 75°
LF	2x 5"
Amp Technology	Digipro®
Amp Class	Class-D
PRG Power	160 W
Cooling	Convection
Controller	DSP 28/56 bit
AD/DA Converter	24bit/48kHz
System Presets	8
Limiter	Dual Active Peak, RMS, Thermal
Signal Input	1x XLR Line In/Mic 1x 6.3mm phone jack 1x RCA cinch AUX with volume ctrl
Microphone Input	Yes
Signal Output	1x 6.3mm phone jack
Power Socket	VDE
Voltage Range	110-120 - 220-240 V
Housing	Polypropylene PP
Angles Up	Monitor use 60°
Rigging Points	2x M5 on side 2x M5 on bottom
Width	200 mm (7.87 in)
Height	335 mm (13.19 in)
Depth	220 mm (8.66 in)
Weight	5.2 kg (11.46 lbs.)

MINIBOX **L160**

A powerful yet surprisingly light cabinet, the remarkably compact L160D offers a variety of connection options to provide convenient sound reinforcement for multimedia applications.

Paired with a DSP, the two 5" phase-corrected loudspeakers deliver astonishingly high sound pressure levels for their size and an amazingly transparent and articulate sonic image.

The multifunctional housing offers wall-mount fixing points for permanent installation and a pole mount for portable use.

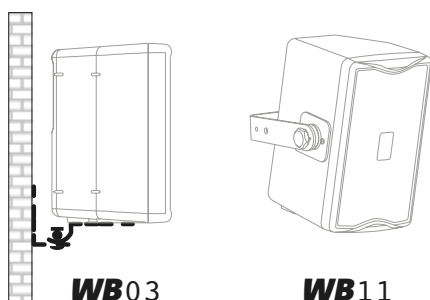

Compact Active Speakers



MINIBOX K SERIES

Active Speakers

The most powerful compact cabinet in its class, the K300 is chock-full of innovative technologies.

Housed in an ultra compact enclosure, its Digipro® bi-amped digital power amp delivers high performance and sound pressure levels. The 1" HF driver renders midrange frequencies with pinpoint precision, and its response is richly detailed.

The integrated DSP further enhances clarity and accuracy, and protects components using digital limiters.



MINIBOX **K70** MINIBOX **K162** MINIBOX **K300**

Speaker Type	2-Way Active Speaker	2-Way Active Speaker	2-Way Active Speaker
Freq. Response [- 10dB]	100 - 18.000 Hz	85 - 19.000 Hz	70 - 20.000 Hz
Max SPL	101 dB	110 dB	118 dB
HF	Tweeter	Tweeter	1" Neodymium driver
LF	5"	2x 6.5"	2x 6.5" Neo
Amp Class	Class-AB	Class-AB	Class-D, Digipro®
PRG Power	100 W	160 W	300 W
Cooling	Convection	Convection	Convection
Controller	Analog	Analog	DSP 24bit/48kHz
Limiter	Soft Clip	Soft Clip	Dual Active, Peak, RMS, Thermal
Signal Input	1x XLR 1x 6.3mm phone jack 1x RCA cinch	1x XLR 1x 6.3mm phone jack 1x RCA cinch	1x XLR 1x 6.3mm phone jack 1x RCA cinch
Microphone Input	Yes	Yes	Yes
Signal Output	1x XLR 1x 6.3mm phone jack 1x RCA cinch	1x XLR 1x 6.3mm phone jack 1x RCA cinch	1x XLR 1x 6.3mm phone jack 1x RCA cinch
Power Socket	VDE	VDE	VDE
Housing	Polypropylene PP	Polypropylene PP	Polypropylene PP
Pole Mount	Optional	Optional	Optional
Rigging Points	2x M5	4x M5	4x M5
Width	170 mm (6.69 in)	210 mm (8.27 in)	210 mm (8.27 in)
Height	270 mm (10.63 in)	350 mm (13.78 in)	350 mm (13.78 in)
Depth	185 mm (7.28 in)	270 mm (10.63 in)	270 mm (10.63 in)
Weight	3.5 kg (7.72 lbs.)	5.5 kg (12.12 lbs.)	5.5 kg (12.12 lbs.)

ELECTRONICS

AC26N

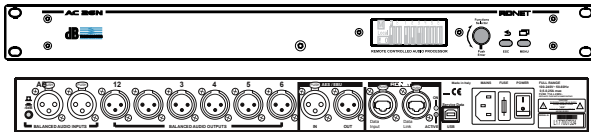

Description

Digital Audio Processor, 2 in - 6 out, Full Range power supply, RDNet Hardware Interface, USB interface, remotable via RDNet or USB. AES-EBU in/out. Max input level 21dBu (without pad) / 27dBu (with -6dB pad). Max output level 21dBu. DSP Processing: 28/56bit - 48Khz. A/D and D/A Converts: 24bit - 96Khz

ASX 24

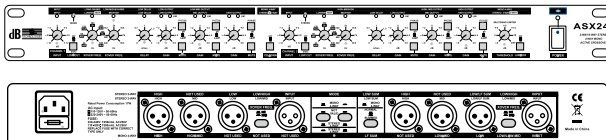

Description

2-Way/3-Way stereo - 4-Way Mono Active Crossover. 2x XLR-Input with 25Hz high-pass filter switch, 6x XLR-Output, high quality 24dB/octave slope Linkwitz-Riley filters, In/Out level controls, xover frequency selection for all bands, mute key and phase reversal for each band, adjustable delay time up to 2ms for outputs, "LOW SUM" function to convey the whole LF range of L&R channels to a mono sub out, multiband limiter with adjustable threshold

CONTROL 2

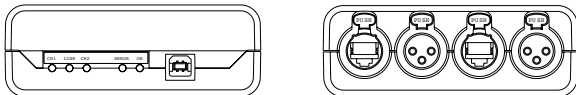

Description

Hardware interface for connecting devices compatible with dBTechnologies RDNet system to a PC through an Ethernet or USB connection. The RDNET CONTROL 2 unit can manage up to 2 subnets. Up to 32 devices can be connected to each subnet (2 subnets x 32 = total 64 devices). The addressing of the various devices is handled automatically by RDNET CONTROL 2 interface.

CONTROL 8

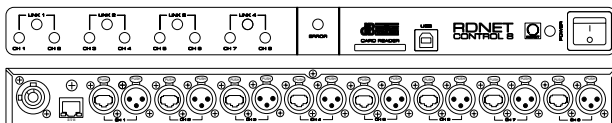

Description

Hardware interface for connecting devices compatible with dBTechnologies RDNet system to a PC through an Ethernet or USB connection. The CONTROL 8 manages up to 8 subnets. Each subnet handles up to 32 devices. So it is possible to control the maximum number of devices managed by this protocol (256) connected with RJ45-RJ45 cables or XLR-XLR balanced audio cables. The addressing of each device is automatically handled by the CONTROL 8.

DSX 2040

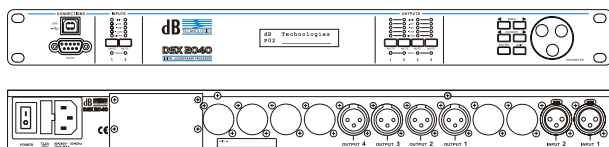

Description

Digital 2 in 4 controller, 48Khz/32-bit signal processing, dynamic range >110dB(A), 3000ms total delay, 4 parameters. EQs per in- and output, programmable x-over and routing-section, editable limiter per output, large LC-Display, bank for 30 presets, USB-interface for programming and data-transfer, 19", 1U, in- and outputs on balanced XLR

SWITCH 6

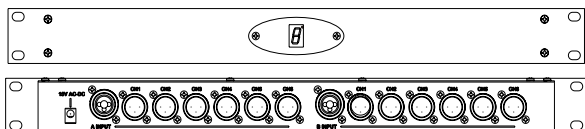

Description

2 x XLR-Input into 2x6 XLR-Output, 1 Unit with LED Display and Remote Control. Up to 6 units in parallel mode

Accessories

BAGS/COVERS

	Description	Designed for
FC-OP10	Functional cover for OPERA 10	OPERA 10
FC-OP12	Functional cover for OPERA 12 or OPERA UNICA 12	OPERA 12 or OPERA UNICA 12
FC-OP15	Functional cover for OPERA 15 or OPERA UNICA 15	OPERA 15 or OPERA UNICA 15
FC-XM12	Functional cover for LVX-XM12	LVX-XM12
FC-XM15	Functional cover for LVX-XM15	LVX-XM15
RC-M1	Magnetic Rain cover for INGENIA, OPERA and OPERA UNICA Series	IG1T / IG2T / IG3T / IG4T / OPERA 10 / OPERA 12 / OPERA 15 / OPERA UNICA 12 / OPERA UNICA 15
RC MS12-SUBH	Rain cover for SUB 15H and 18H	SUB 15H / SUB 18H
TC-160D	Bag for two MINIBOX L160D	2x L160D
TC-BH8	Transport cover for B-Hype 8	B-Hype 8
TC-BH10	Transport cover for B-Hype 10	B-Hype 10
TC-BH12	Transport cover for B-Hype 12	B-Hype 12
TC-BH15	Transport cover for B-Hype 15	B-Hype 15
TC-ES10	Transport cover for ES 602 subwoofer	ES 602 subwoofer
TC-ES12	Transport cover for ES 503 or ES 802 subwoofer	ES 503 or ES 802 subwoofer
TC-ES212	Transport cover for ES 1002 or ES 1203 sub	ES 1002 or ES 1203 subwoofer
TC-ES44	Bag for 2 ES 1203 tops, D35mm pole and cable	2x ES 1203 top
TC-ES84	Bag for ES 1002 top or DP-ES1203	ES 1002 top or DP-ES1203
TC-ESTOP	Transport cover for two ES tops (ES 503 or ES 802), D25mm pole and cable	2x ES top (ES 503 or ES 802) or 2x L80D
TC F8	Transport cover for LVX 8	LVX 8
TC F10	Transport cover for LVX 10	LVX 10
TC F12	Transport cover for LVX 12	LVX 12
TC F15	Transport cover for LVX 15	LVX 15
TC-IG1T	Transport cover for IG1T	IG1T
TC-IG2T	Transport cover for IG2T	IG2T
TC-IG3T	Transport cover for IG3T	IG3T
TC-IG4T	Transport cover for IG4T	IG4T
TC-S615	Transport cover for SUB 615	SUB 615
TC-S618	Transport cover for SUB 618	SUB 618
TC-S915	Transport cover for SUB 915	SUB 915
TC-S918	Transport cover for SUB 918	SUB 918
TT 06	Cover for K-Series speakers	K 162 / K 300

CABLES

	Description	Designed for
C-01	PowerCon-Out cable IEC, 2m [6.56 feet]	All speakers with PowerCon mains input
C-02	VDE-Shuko mains cable, 10m [32.8 feet]	All speakers with PowerCon mains input
CAT6-CAT6-170	CAT6-CAT6 link cable (170cm) for DANTE™ AoIP and RDNet. EtherCON connectors.	SUB 915 / SUB 918
CAT6-CAT6-500	CAT6-CAT6 link cable (500cm) for DANTE™ AoIP and RDNet. EtherCON connectors.	SUB 915 / SUB 918
DCK-4P	Kit composed by 2x speakon cables (4 p), 7m [23 feet]	ES 503 / ES 1203
DAC-70	XLR-XLR Audio Cable (70cm)	IG1T / IG2T
DAC-100	XLR-XLR Audio Cable (100cm)	IG3T / IG4T
DAC-500	XLR-XLR Audio Cable (500cm)	SUBs 600 / SUBs 900 / SIGMAs
DPC-240A	PowerCon Gray Link-PowerCon TRUE1 In Link cable use to link SUB-15H/18H to Ingenia Series (240 cm)	All SUB-H models with all INGENIA models
DPTC-1000M	Mains power cable with PowerCon TRUE1 (10m)	All INGENIA models / SUBs 900
DPTC-2000M	Mains power cable with PowerCon TRUE1 (20m)	All INGENIA models / SUBs 900
DPTC-120L	PowerCon TRUE1-PowerCon TRUE1 Link cable (120cm)	IG1T / IG2T
DPTC-160L	PowerCon TRUE1-PowerCon TRUE1 Link cable (160 cm)	IG3T / IG4T / SUB 915 / SUB 918
RDC-45F	RJ45 to XLR 3 poles female conversion cable, 6 cm length. The cable converts from RDNet RJ45 to XLRf.	All RDNet speakers
RDC-45M	RJ45 to XLR 3 poles male conversion cable, 6 cm length. The cable converts from RDNet RJ45 to XLRM.	All RDNet speakers

Accessories

INSTALLATION

ES ACCESSORIES

DP-ES1203 / DP-ES1203W



Description

Designed pole for ES 1203 or ES 1002. White available

Designed for

ES 1203 or ES 1002

DS-25D



Description

Pole Mount Ø 25mm, adjustable, M20 thread.

Designed for

ES 503 or ES 802

SK-25TT



Description

Kit composed by 2x Tripods (D25mm) + bag

Designed for

ES 503

WB-25V



Description

Wall bracket for ES 503 / 602 / 802 top. It can be used for vertical wall mounting

Designed for

ES 503 / 802 tops

WB-44



Description

Wall bracket for ES 1203 top.

Designed for

ES 1203 tops

INGENIA ACCESSORIES

DRK-IG



Description

Fly-bar for INGENIA Series

Designed for

IG1T / IG2T / IG3T / IG4T

GSA-IGA



Description

Adjustable adapter for ground-stacking INGENIA speakers on dBTechnologies subs

Designed for

IG1T / IG2T / IG3T / IG4T

LP-IG



Description

Link bracket for INGENIA Series. Sold in pairs

Designed for

IG1T / IG2T / IG3T / IG4T

M10B-IG1T

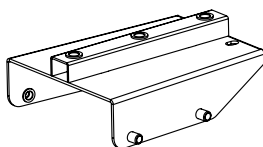

Description

M10 / Spigot bracket for IG1T

Designed for

IG1T

RDNet-EH



Description

Handle for RDNet control on INGENIA speakers (1x single speaker/1x coupled speakers)

Designed for

IG1T / IG2T / IG3T / IG4T

STA-IG



Description

Spigot truss adapter for INGENIA Series

Designed for

IG1T / IG2T / IG3T / IG4T

Accessories

TA-IG



Description

DRK-IG flybar half coupler adapter.

Designed for

IG1T / IG2T / IG3T / IG4T

WB-IG14



Description

Wall bracket for mounting IG1T or IG4T, 1 or 2 coupled speakers vertically, only 1 horizontally

Designed for

IG1T / IG4T

WB-IG2



Description

Wall bracket for mounting IG2T, 1 or 2 coupled speakers vertically, only 1 horizontally

Designed for

IG2T

LVX BRACKETS

WB-L8H / WB-L8HW



Description

Horizontal wall mounting bracket for LVX 8. White available

Designed for

LVX 8

WB-L10H / WB-L10HW



Description

Horizontal wall mounting bracket for LVX 10. White available

Designed for

LVX 10

WB-L12H / WB-L12HW



Description

Horizontal wall mounting bracket for LVX 12. White available

Designed for

LVX 12

WB-L15H / WB-L15HW



Description

Horizontal wall mounting bracket for LVX 15. White available

Designed for

LVX 15

WB-L8V / WB-L8VW

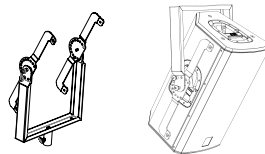

Description

Vertical wall mounting bracket for LVX 8. White available

Designed for

LVX 8

WB-L10V / WB-L10VW

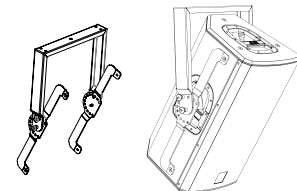

Description

Vertical wall mounting bracket for LVX 10. White available

Designed for

LVX 10

WB-L12V / WB-L12VW

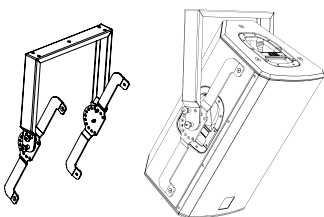

Description

Vertical wall mounting bracket for LVX 12. White available

Designed for

LVX 12

WB-L15V / WB-L15VW

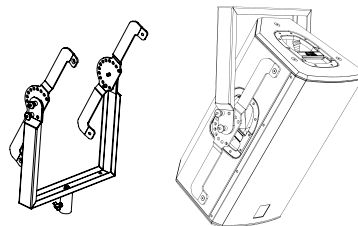

Description

Vertical wall mounting bracket for LVX 15. White available

Designed for

LVX 15

Accessories

MINIBOX ACCESSORIES

AK 50



Description

Removable handle for MINIBOX K162 and K300.

Designed for

K 162 / K 300

SA25



Description

D25mm speaker stand adaptor for MINIBOX Series. Tilt adjustable gear and locking screw

Designed for

L 80D / L 160D / K 70 / K 162 / K 300

SN 130



Description

MINIBOX Adapter for Microphone stands.

Designed for

L 80D / L 160D / K 70 / K 162 / K 300

WB 03 / WB 03W



Description

Swivel and tilt wall-mount bracket for MINIBOX Series. White available

Designed for

L 80D / L 160D / K 70 / K 162 / K 300

WB 11



Description

Universal wall mount bracket for MINIBOX Series

Designed for

L 80D / L 160D / K 70 / K 162 / K 300

OPERA BRACKETS

WB-OP10

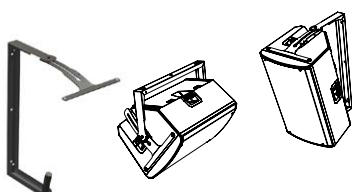

Description

Horizontal/Vertical wall bracket.

Designed for

OPERA 10

WB-OP12

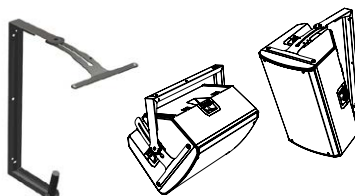

Description

Horizontal/Vertical wall bracket.

Designed for

OPERA 12 / OPERA UNICA 12

WB-OP15

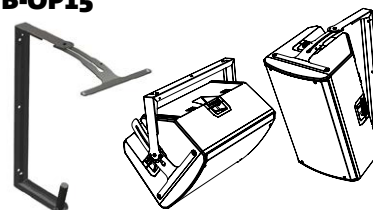

Description

Horizontal/Vertical wall bracket.

Designed for

OPERA 15 / OPERA UNICA 15

MISCELLANEOUS

BP-M20

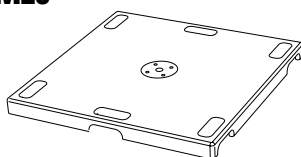

Description

Base plate for securing SIGMA S218, with M20

Designed for

SIGMA S218

DS-2



Description

Pole Mount 35mm, adjustable, M20 thread.

Designed for

SUBs H / SUBs 600 / SUBs 900 / LVX PSWs

DS2-S



Description

Pole Mount M20 thread, 20cm length.

Designed for

SUBs H / SUBs 600 / SUBs 900 / LVX PSWs

Accessories

DS-35D



Description

Pole Mount Ø 35mm, adjustable, M20 thread.

Designed for

SUBs H / SUBs 600 / SUBs 900 / LVX PSWs

SK-36TT



Description

Kit composed by 2x Tripods (D35mm) + bag

Designed for

All speakers with D36mm pole mount cup

TE M8



Description

Eye-bolt set (4 pcs) with M8-thread

Designed for

LVX 8 / LVX 10 / LVX Passive

TE M10



Description

Eye-bolt set (4 pcs) with M10-thread

Designed for

LVX 12/15

WB 09



Description

Universal wall mount bracket, swivel and tilt Ø35mm pole mount

Designed for

All speakers with Ø 36mm pole mount cup

TRANSPORT

DO-ES1203



Description

Transport dolly for ES 1203 or ES 1002

Designed for

ES 1203 / ES 1002

DT-50



Description

Trolley for ES 503 and SUB 28D + 2x L160D

Designed for

ES 503 / SUB 28D + 2x L160D

SWK-18 kit



Description

Kit composed by 4 wheels for SUBs 900

Designed for

SUBs 900

BUNDLES

Stereo Kit ES503

Description

Kit composed by 2x tripods + bag for tripods + 2x 7m speakon cables

Designed for

ES 503

TK-160+28

Transport kit composed by bag for L160D, bag for SUB 28D and DT-50 trolley

SUB 28D, L160D

TK-ES12

Transport kit composed by bag for ES 503 tops, bag for ES 503 sub and DT-50 trolley

ES 503

Find all products datasheets on
www.dbtechnologies.com

Features, specification and appearance of products are subject to change without notice. dBTechnologies reserves the right to make changes or improvements in design or manufacturing without assuming any obligation to change or improve products previously manufactured.

dBTechnologies*Italy & International sales***AEB Industriale Srl**

Via Brodolini, 8 - Loc. Crespellano
40053 Valsamoggia (BO) ITALY
Tel +39 051 96 98 70
Fax +39 051 96 97 25
info@dbtechnologies-aeb.com

dBTech USA*US sales***dBTech USA Inc.**

OFFICE: 407 Lincoln Road, Suite 4E
Miami Beach FL 33139, USA
LEGAL ADDRESS: 1221 Brickell Avenue,
Suite 1160
Miami FL 33131, USA

dBTechnologies Deutschland GmbH*Germany, Belgium, Netherlands, Luxembourg,
Austria*

Hansestrasse 93
51149 Köln
Tel. +49 (0)2203 925370
Fax. +49 (0)2203 9253773
verkauf@dbtechnologies.de

**dBTechnologies***www.dbtechnologies.com*